

Concept Design: Pacific/Main/Central

Legend

- Traffic Light
- Rapid Flashing Beacon
- Stormwater Garden
- Street Tree
- AC Transit Bus Stop

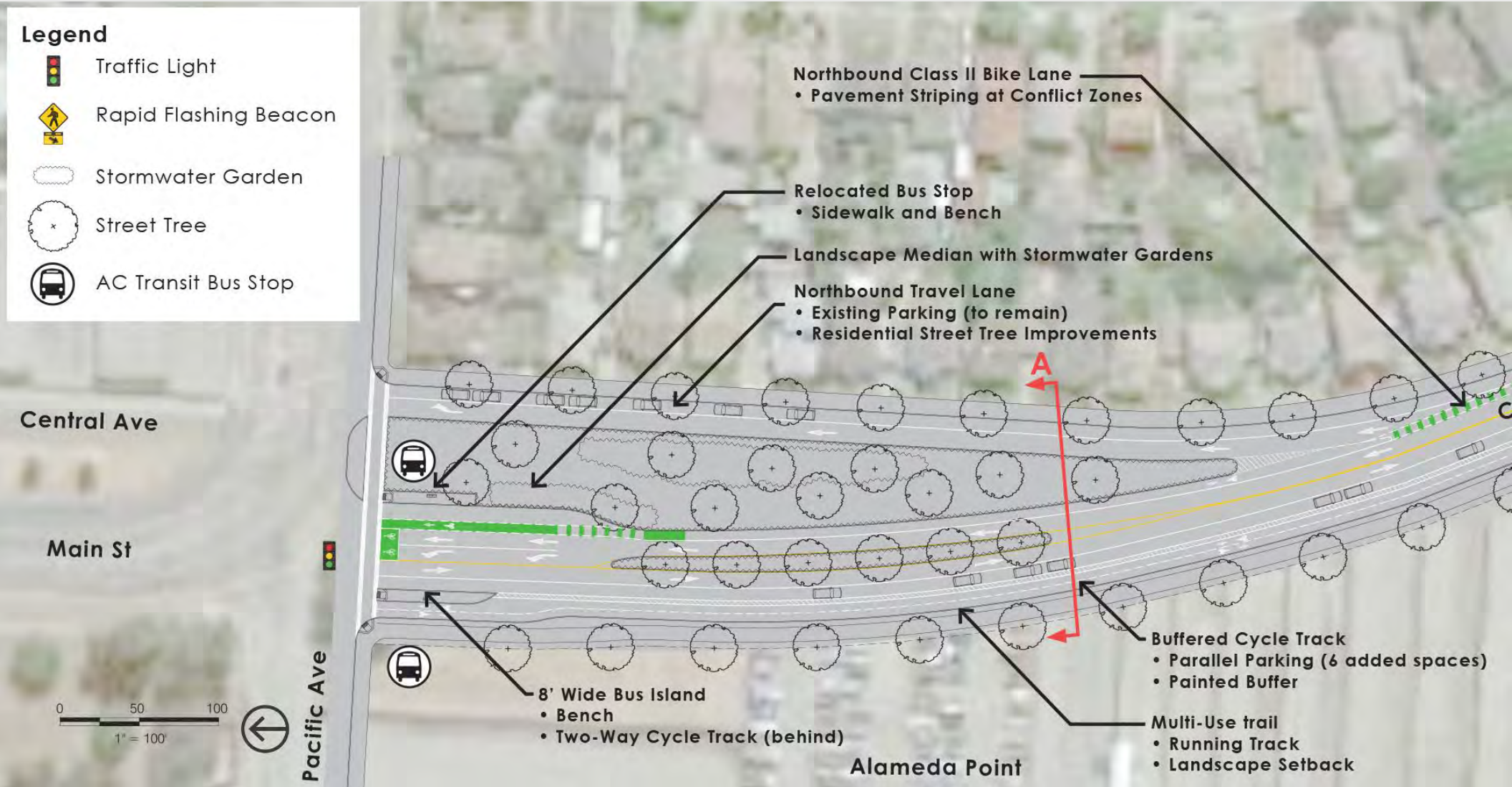

Central Avenue Proposed Street Concept

Concept Design: Pacific/Main/Central

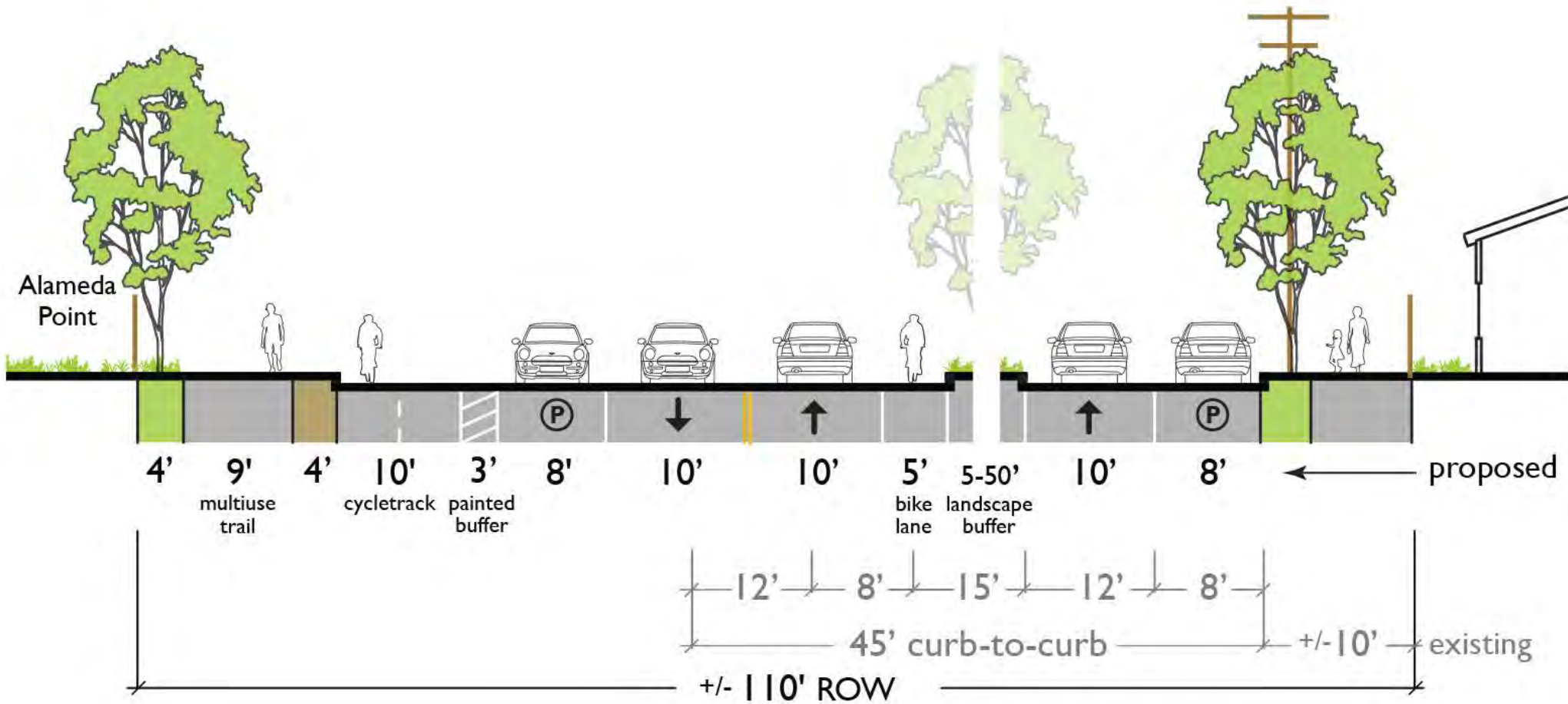

Section A

Concept Design: Lincoln/Boat Ramp

Legend

- Traffic Light
- Rapid Flashing Beacon
- Stormwater Garden
- Street Tree
- AC Transit Bus Stop

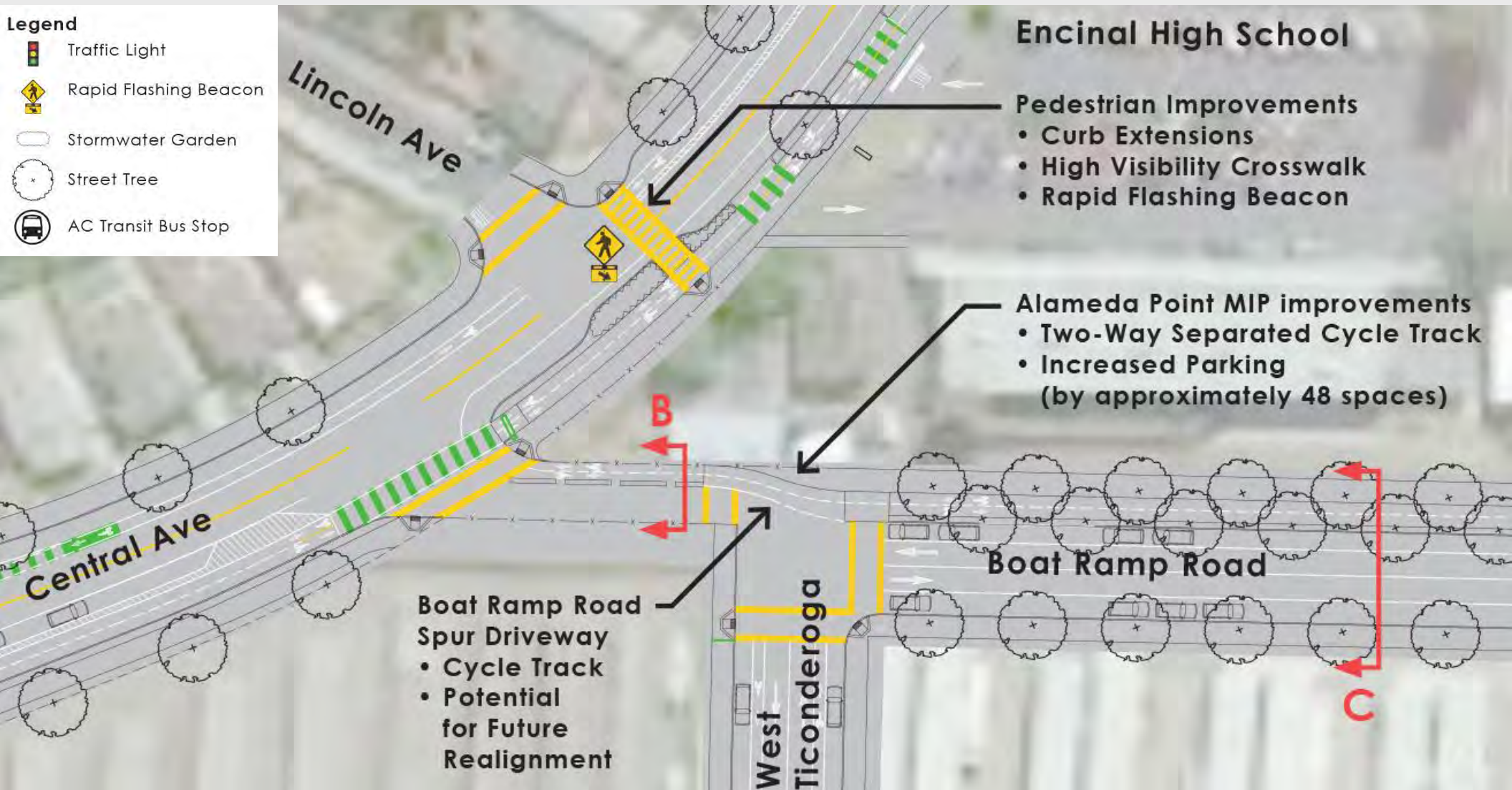

Concept Design: Boat Ramp Road

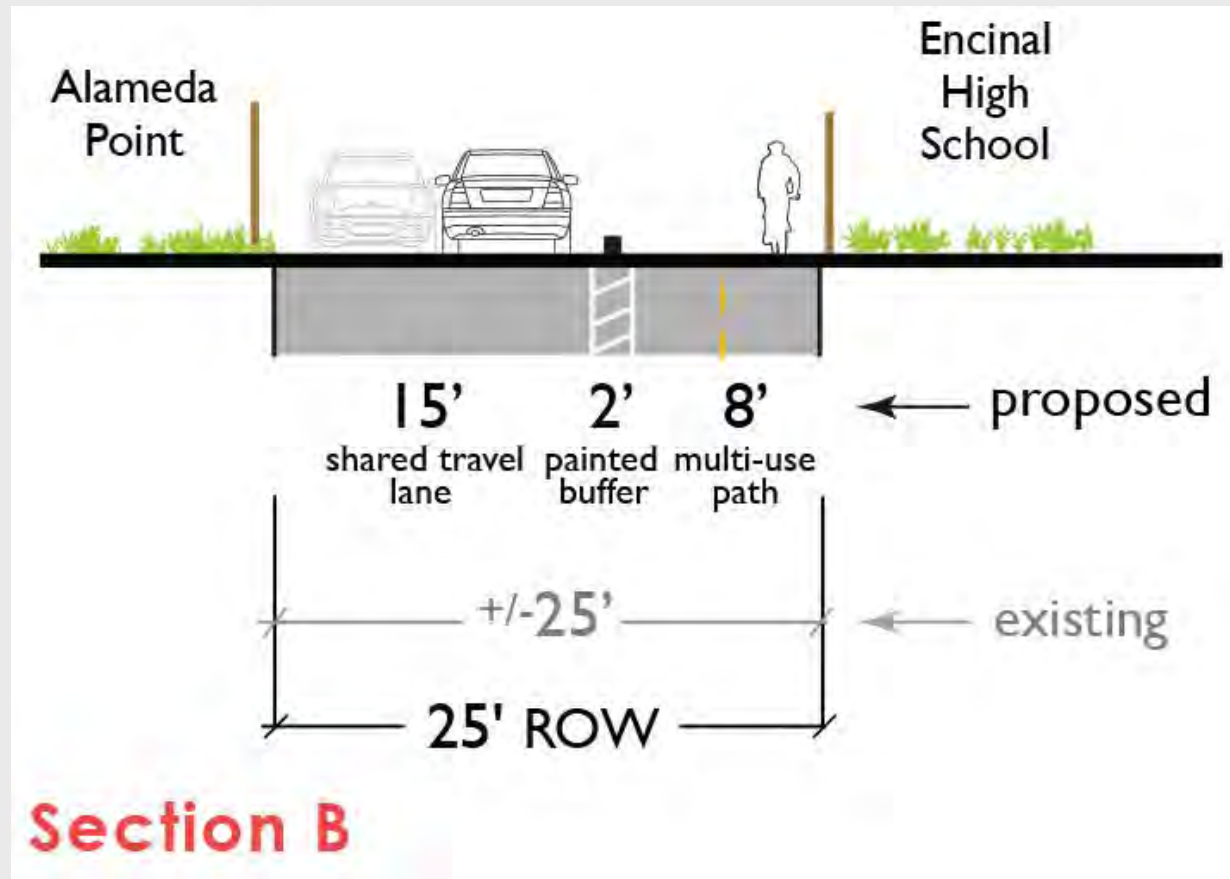

Concept Design: Boat Ramp Road

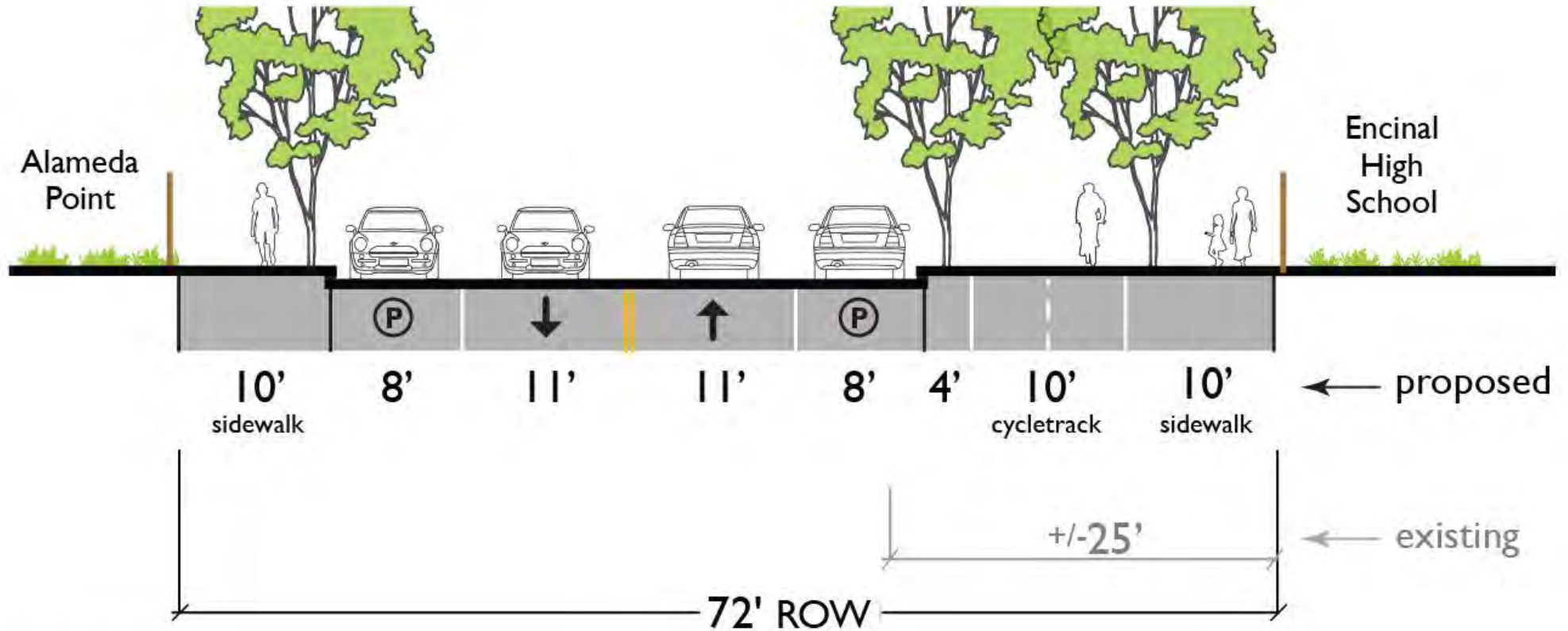

Section C

Concept Design: Encinal High School

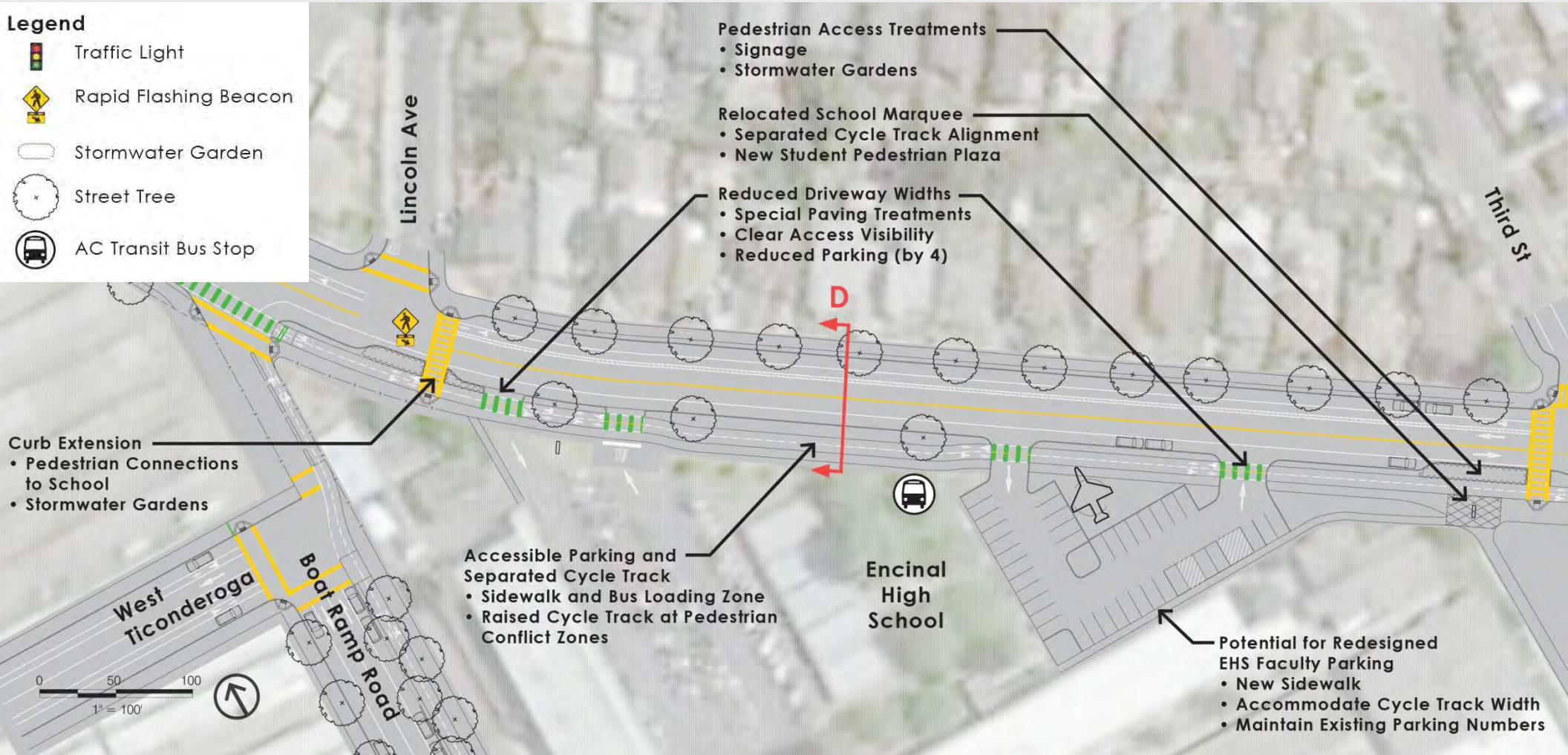

Concept Design: Encinal High School

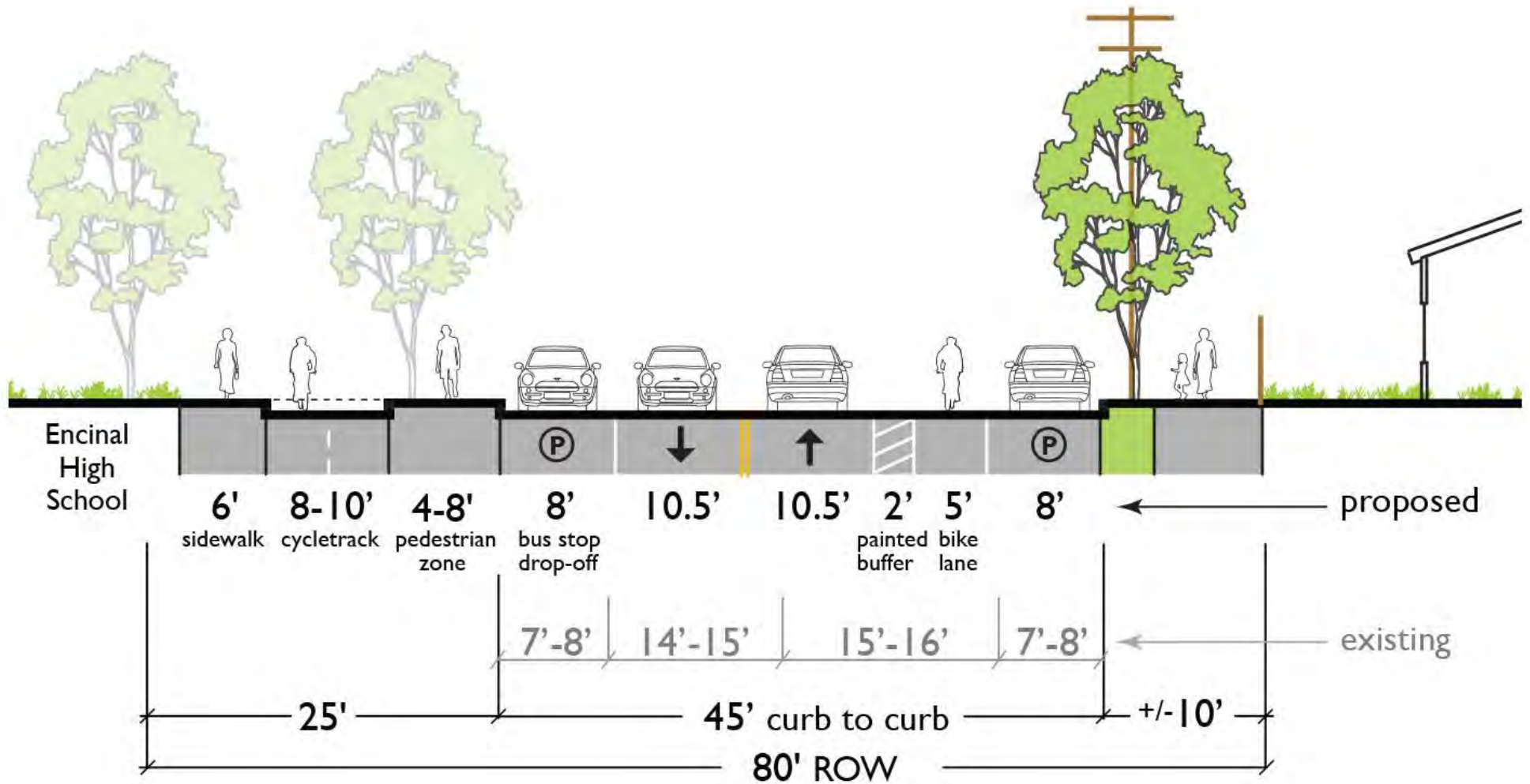

Section D

Concept Design: Third/Taylor/Central

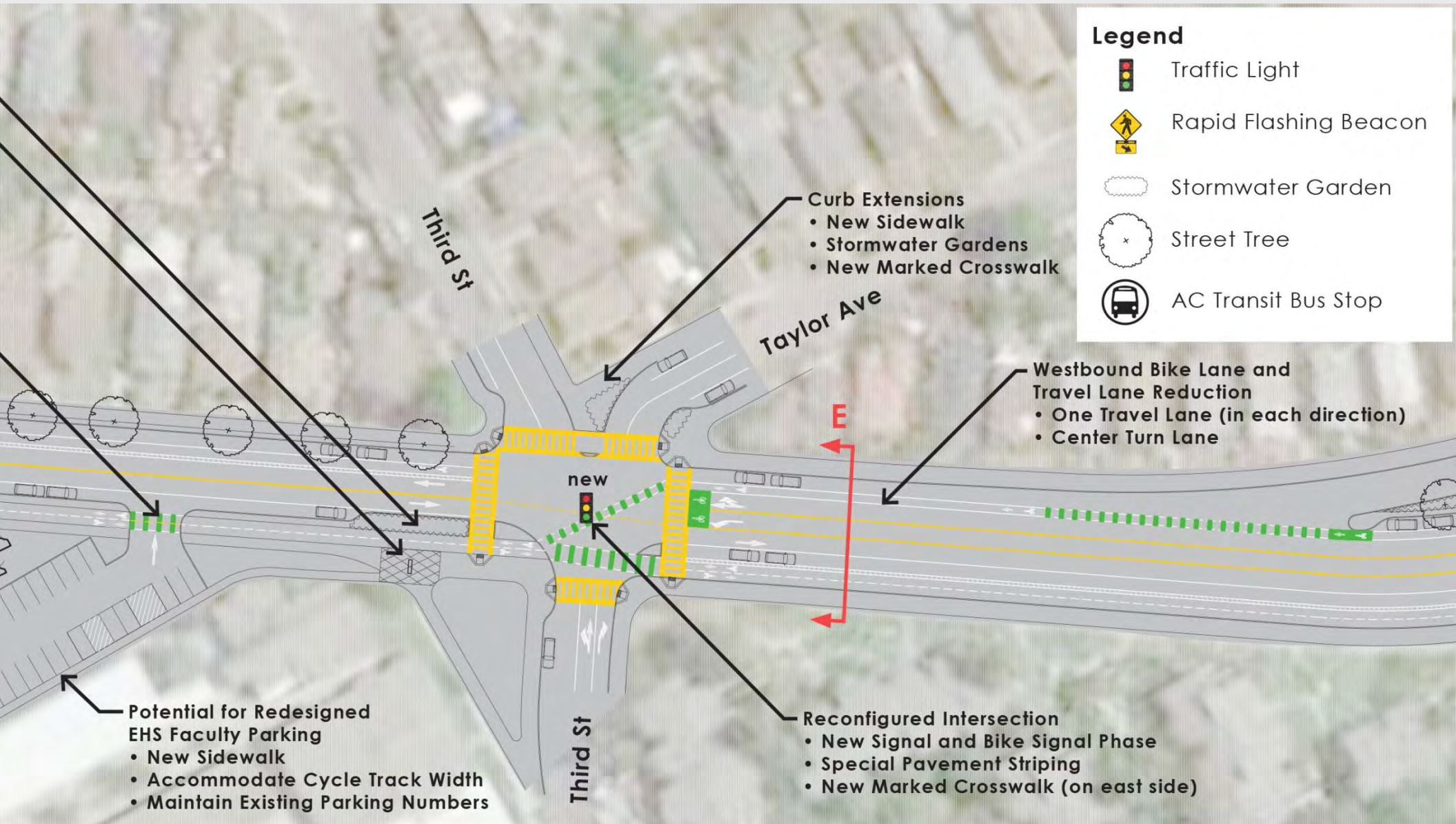

Concept Design: East of Third/Taylor

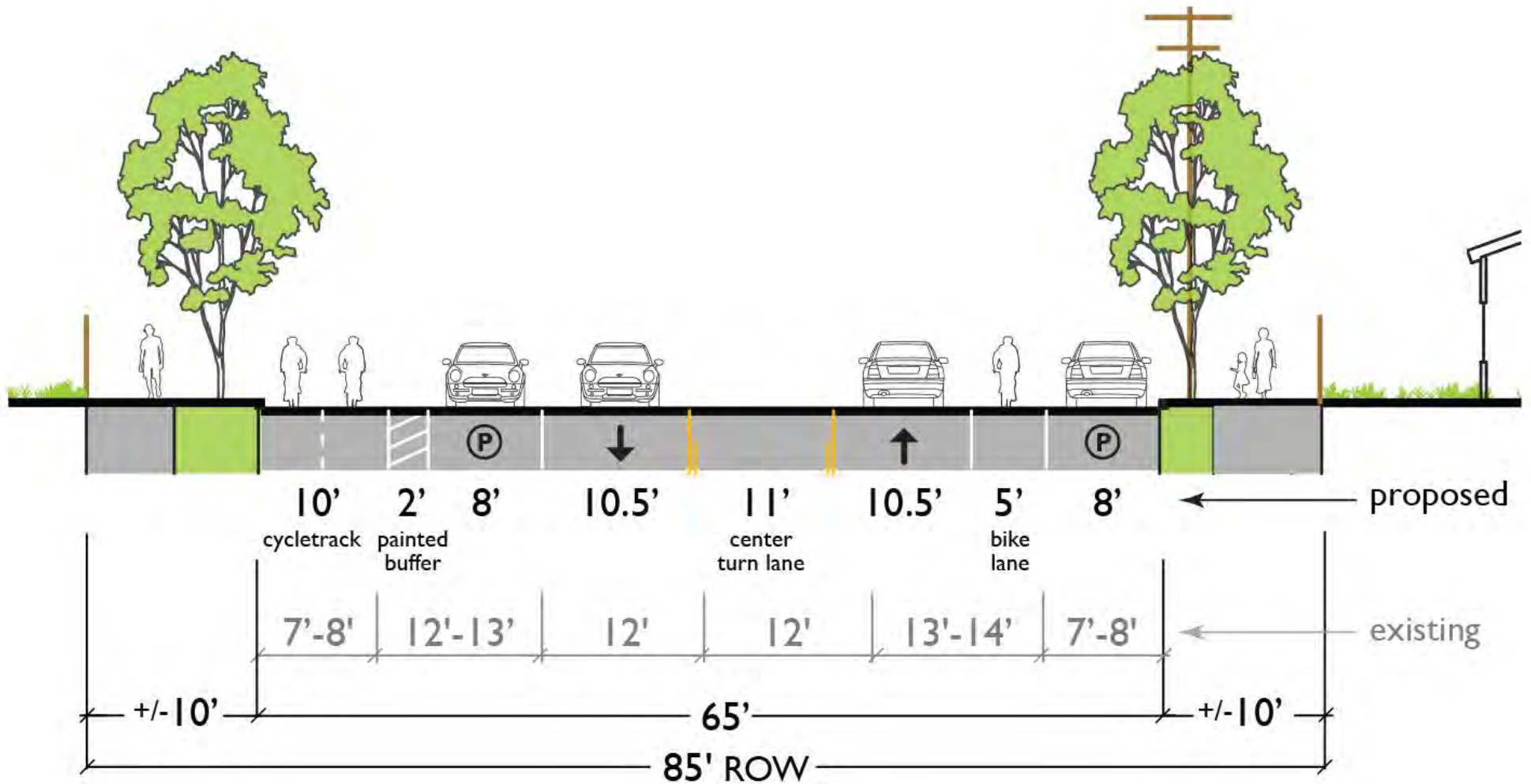

Section E

Concept Design: Fourth/Ballena/Central

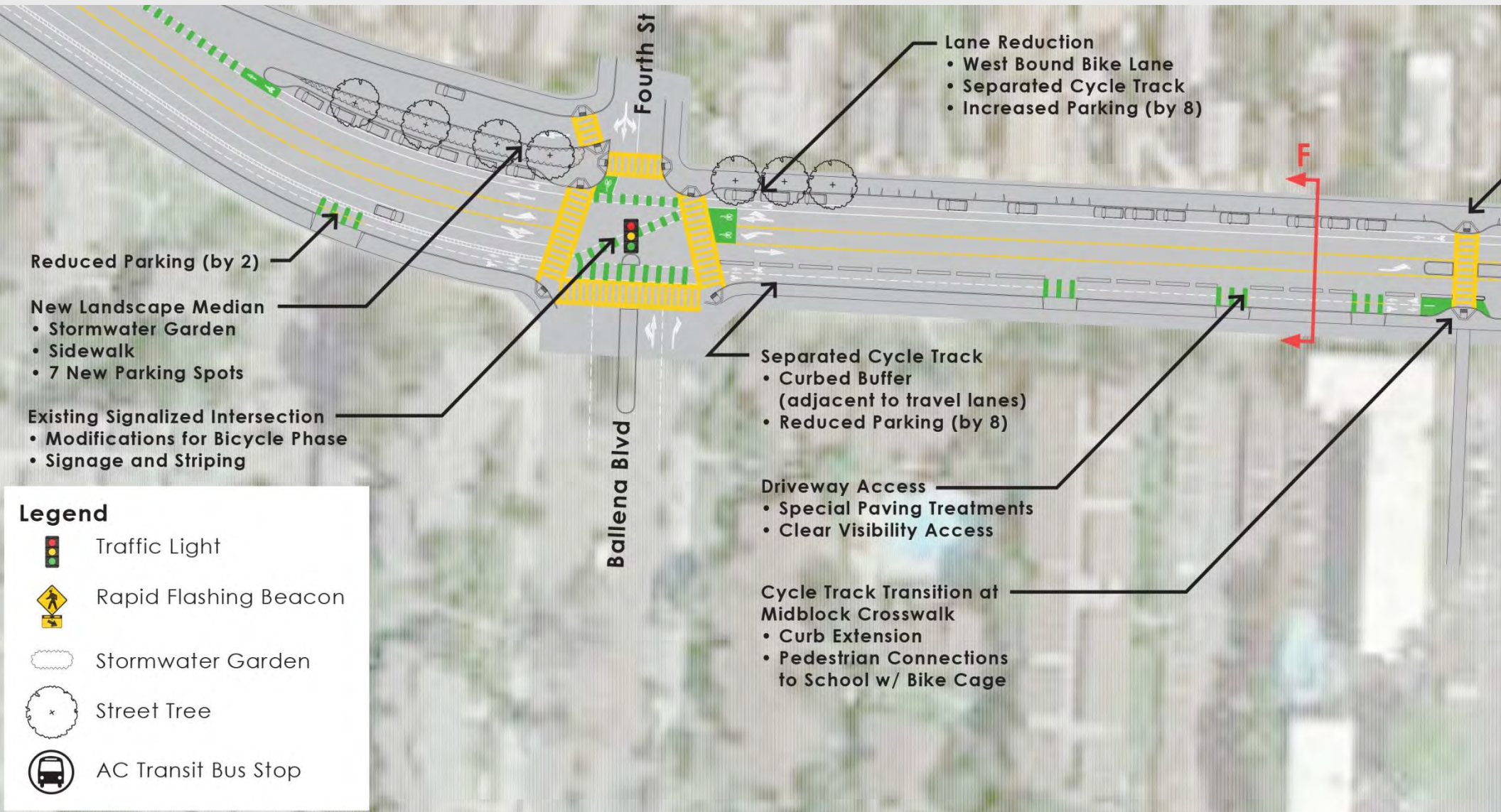

Concept Design: West of Paden

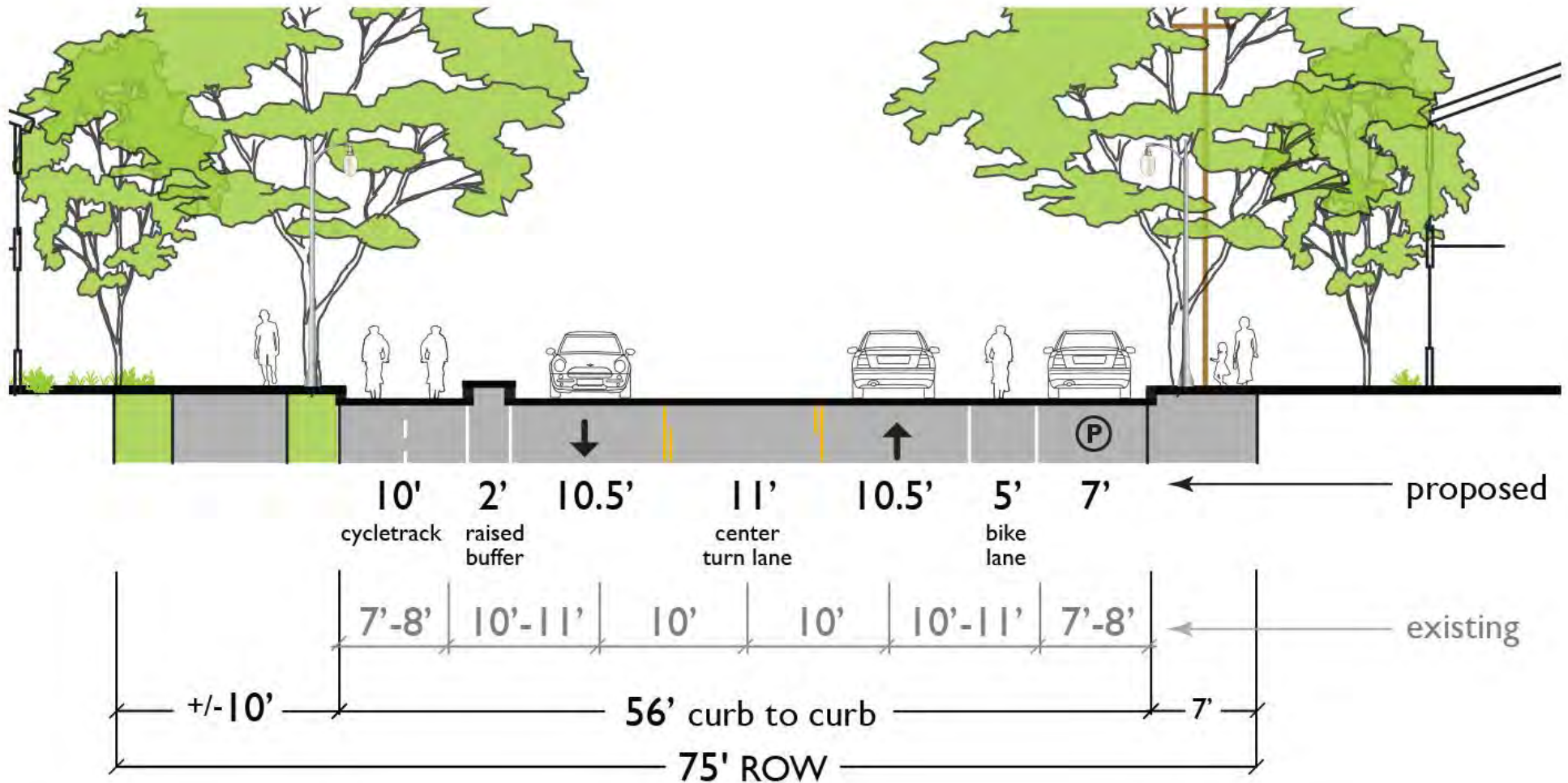

Section F

Concept Design: Paden Elementary

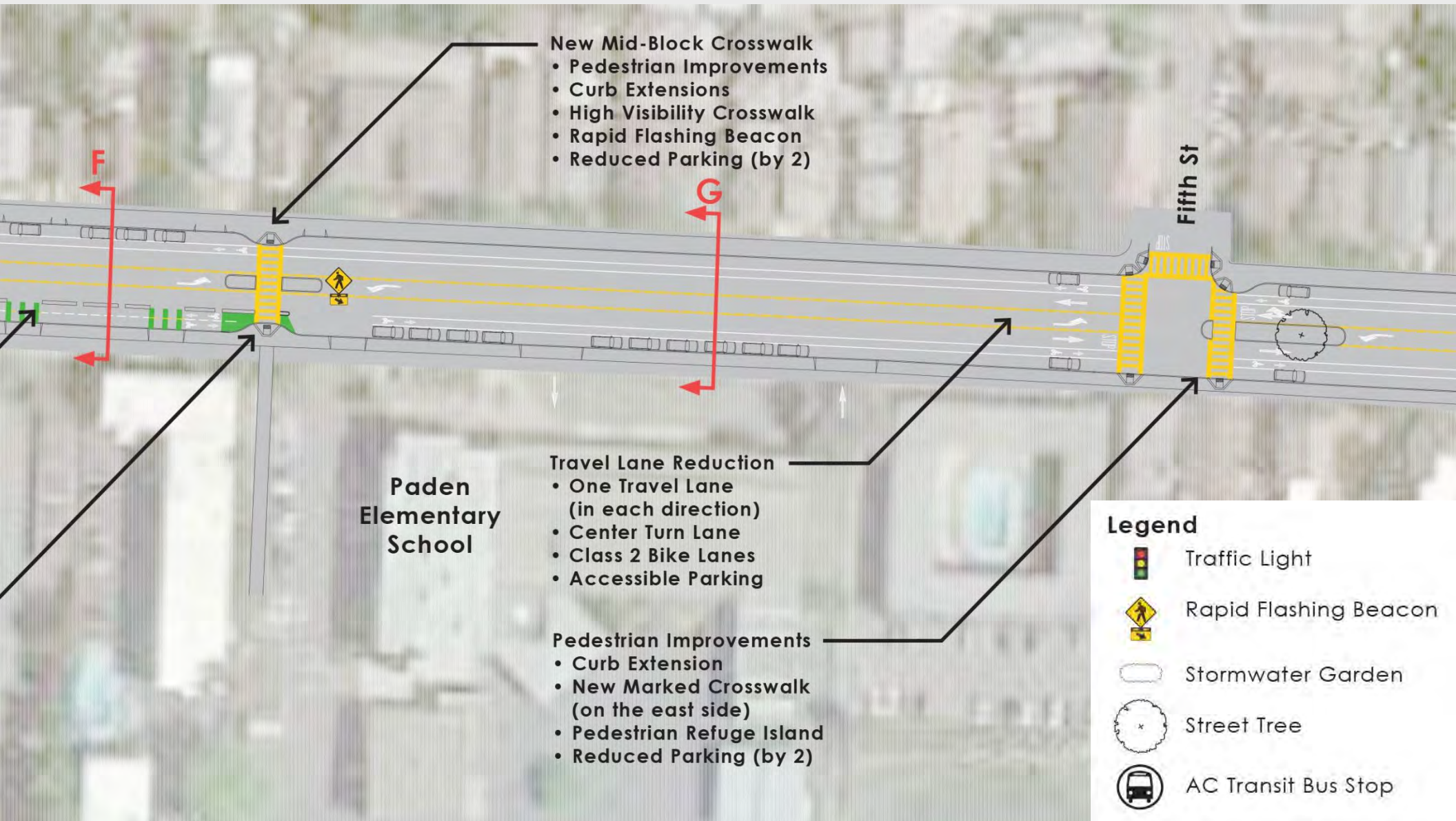

Concept Design: East of Paden

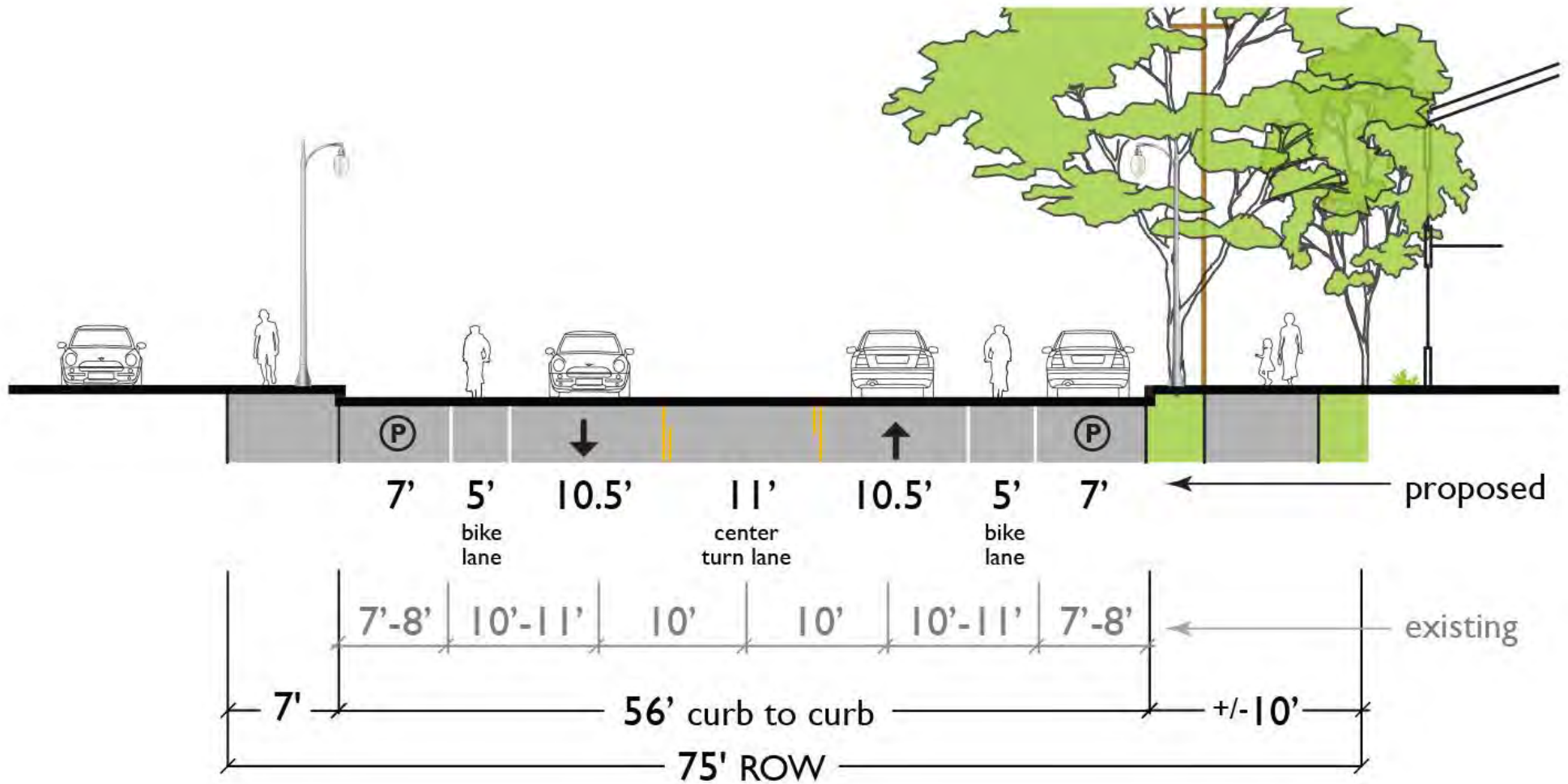

Section G

Concept Design: Fifth to Sixth

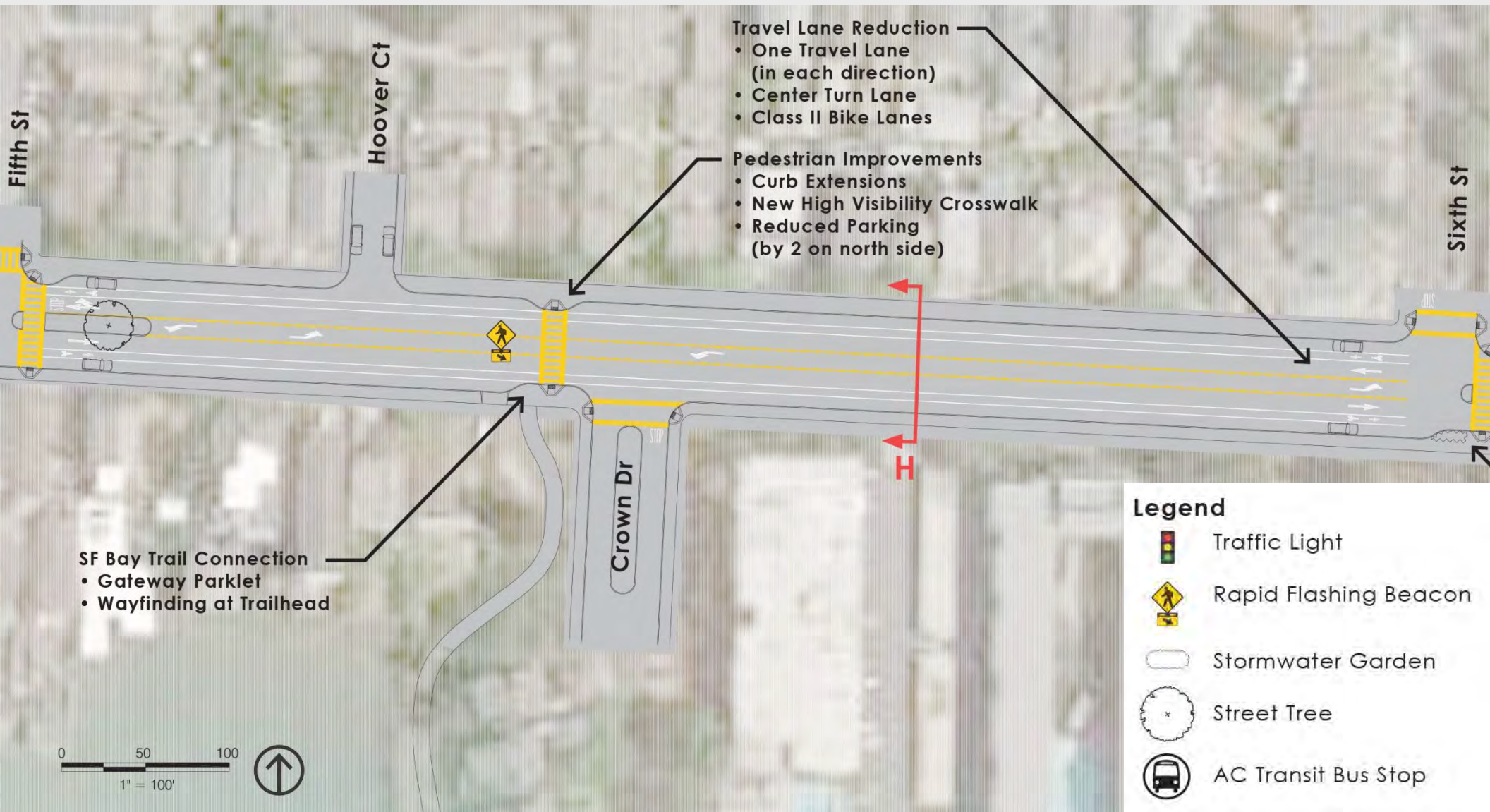

Concept Design: Fifth to Sixth

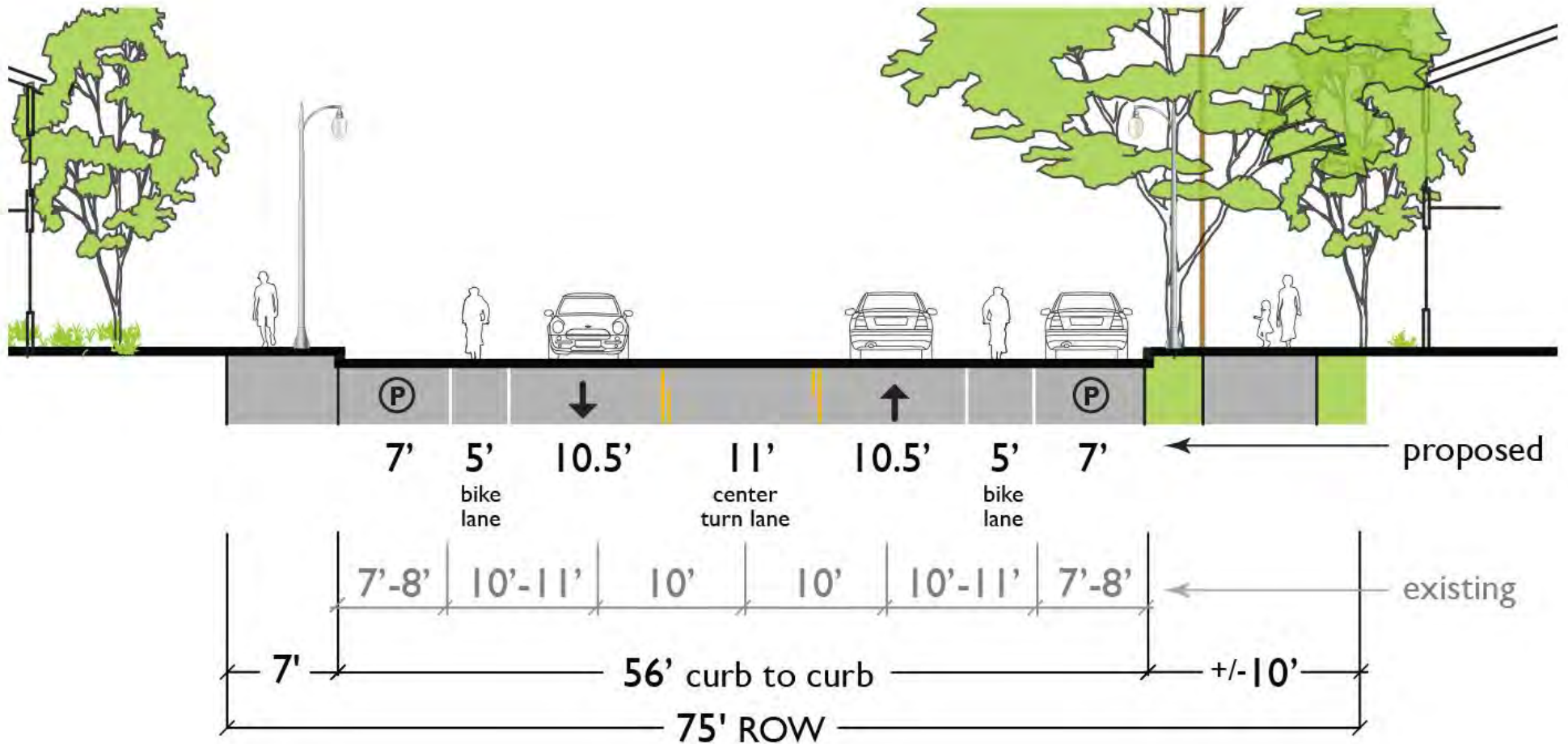

Section H

Concept Design: Sixth to Webster

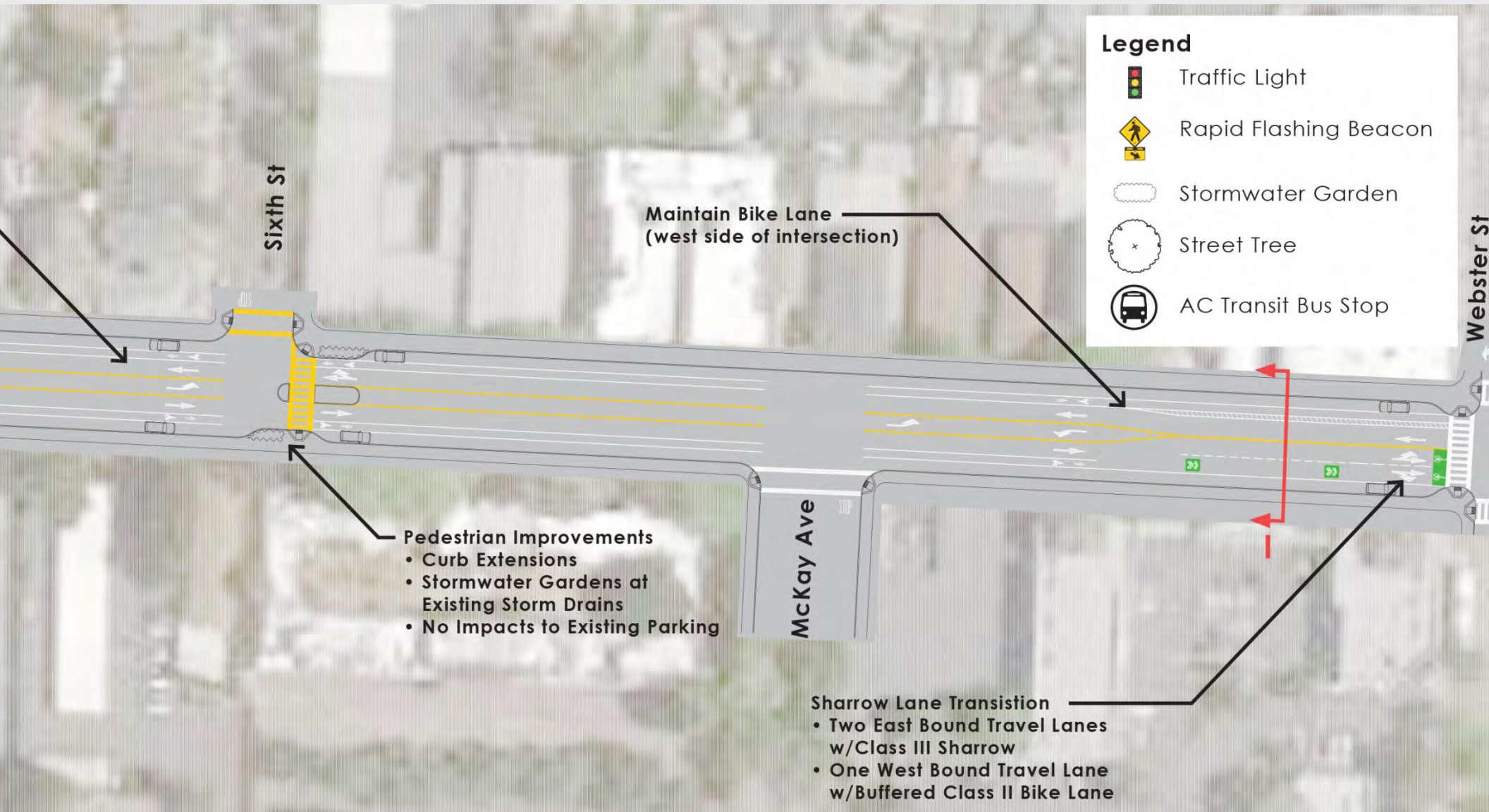

Concept Design: Sixth to Webster

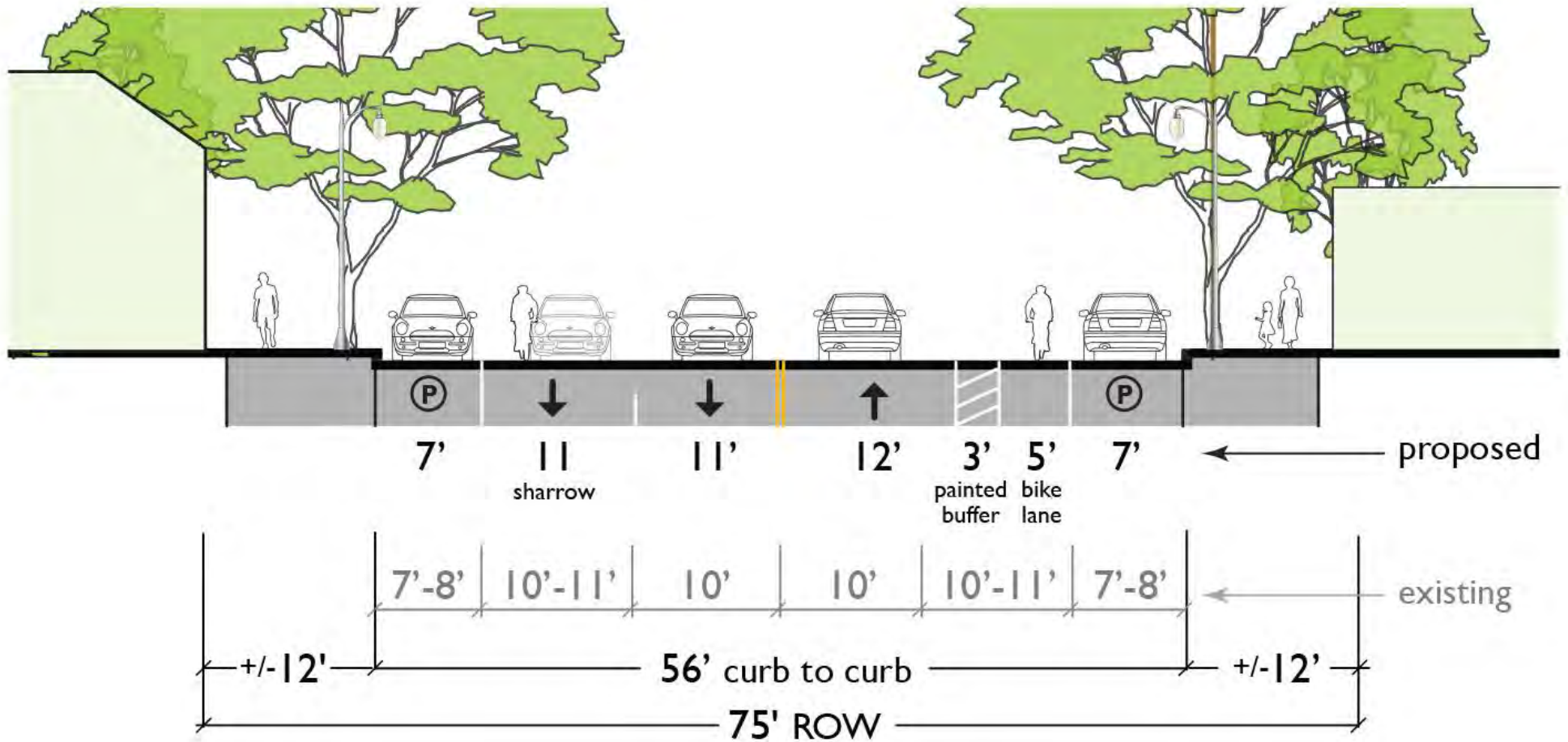

Section I

Concept Design: Webster to Page

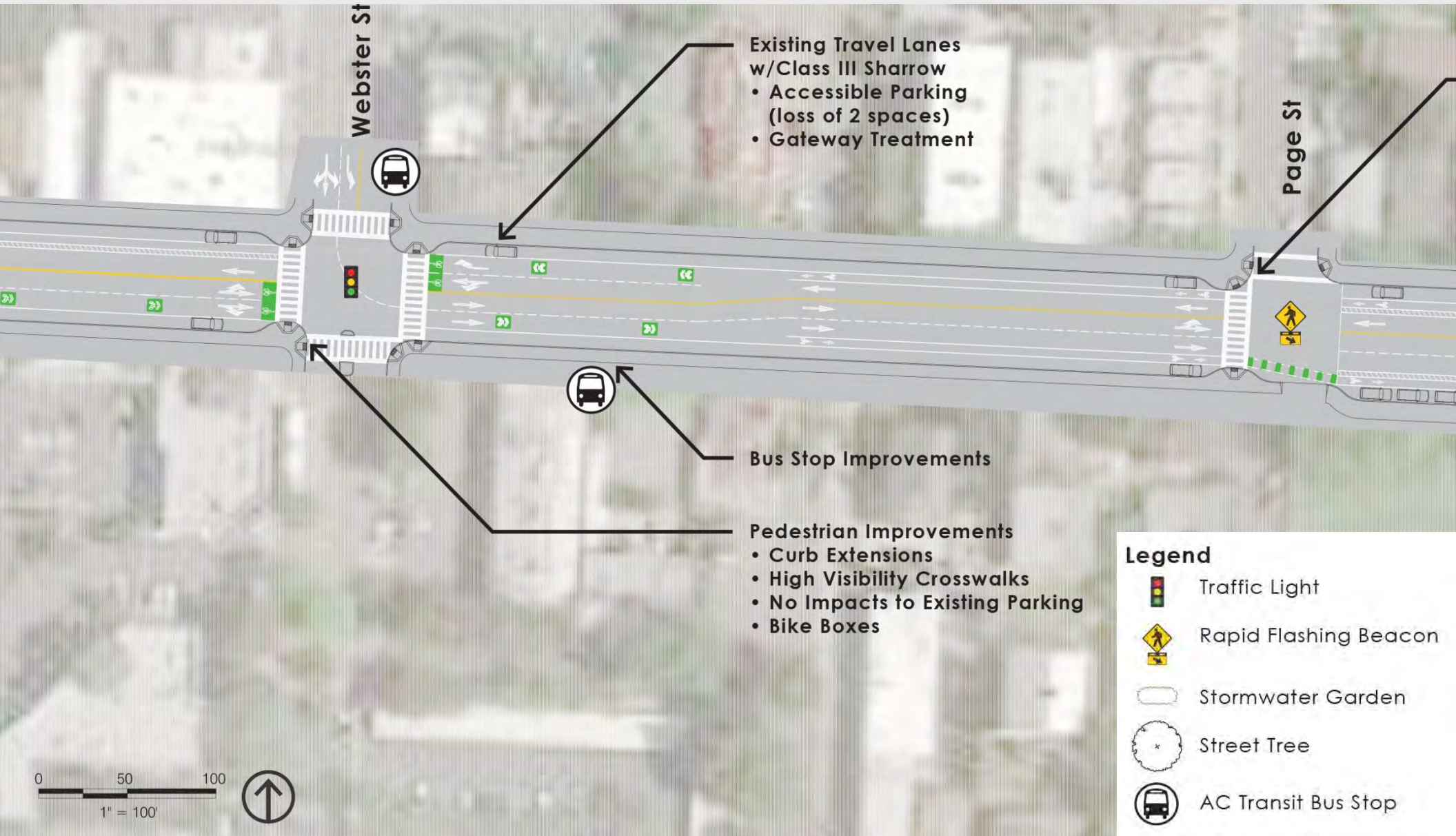

Concept Design: Page to Eighth

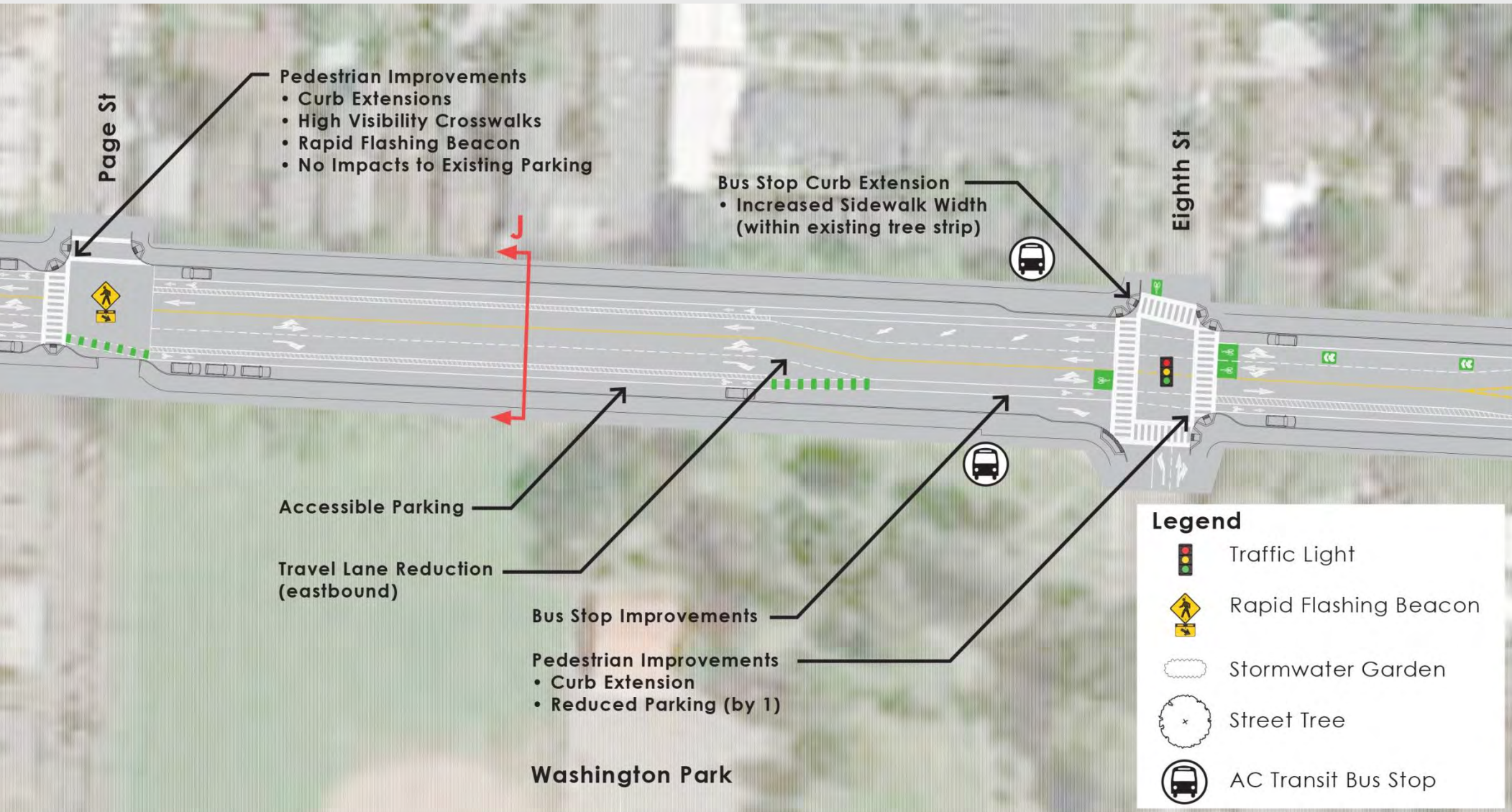

Concept Design: Page to Eighth

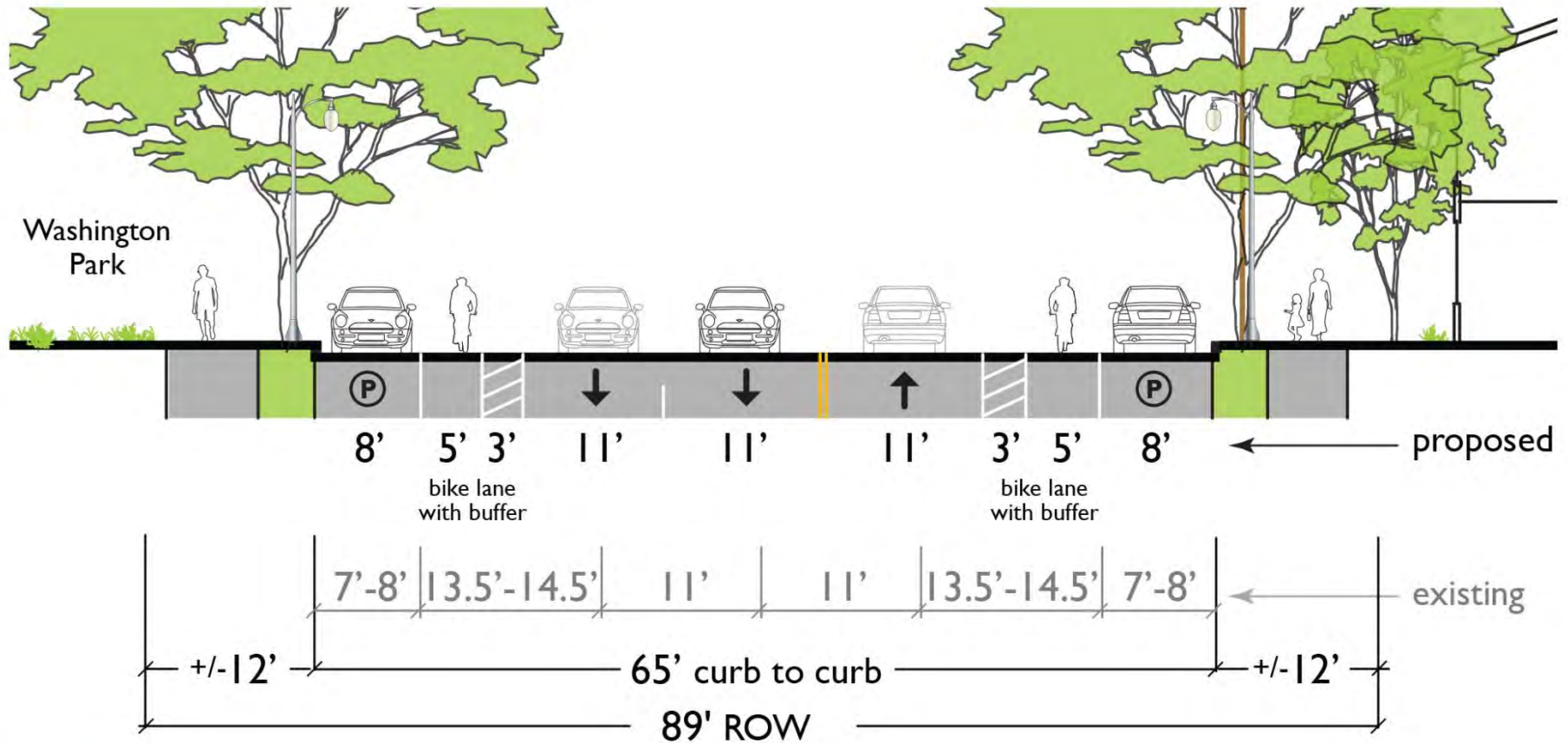

Section J

Concept Design: Eighth to Ninth

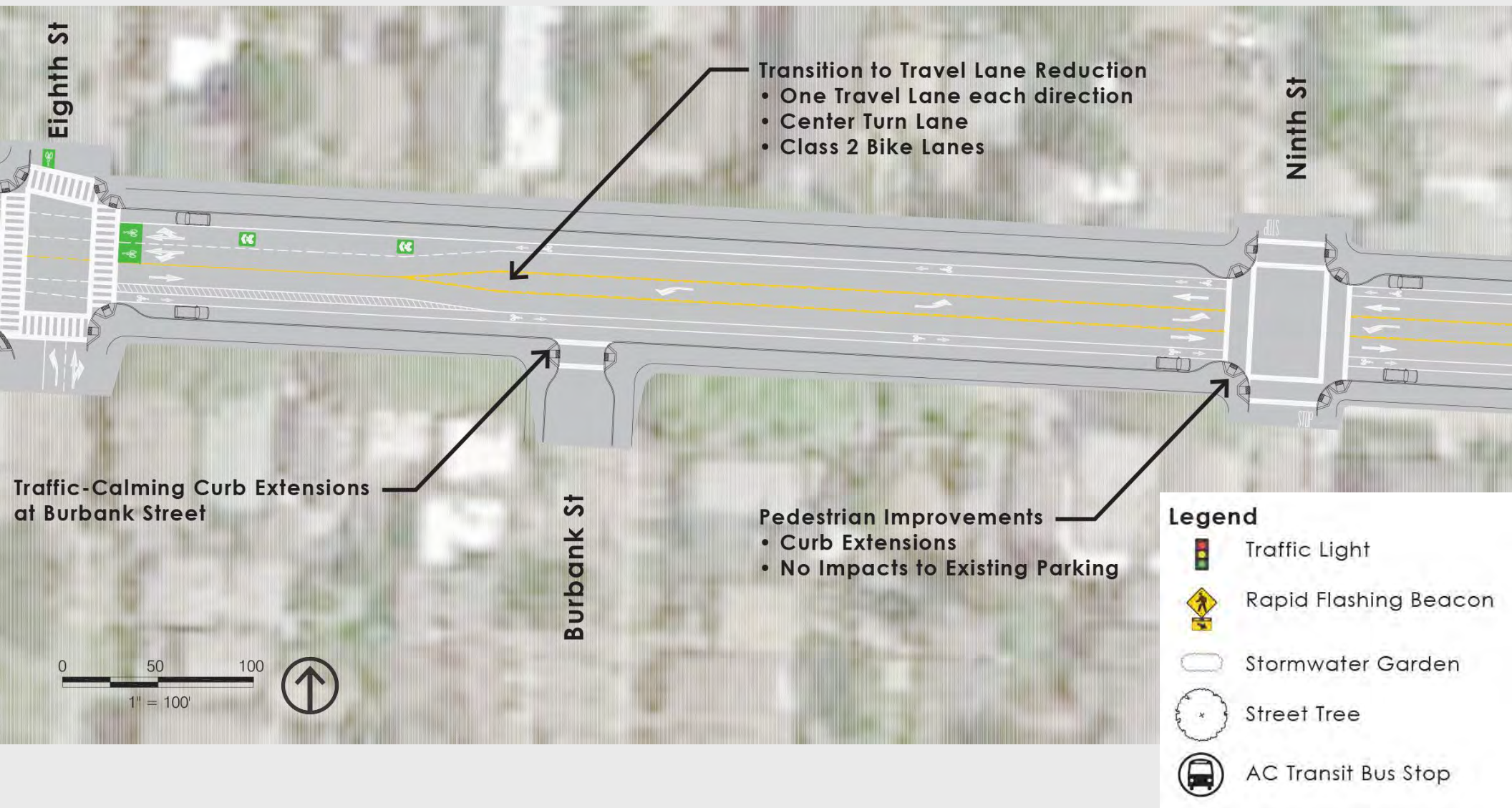

Concept Design: Eighth to Sherman

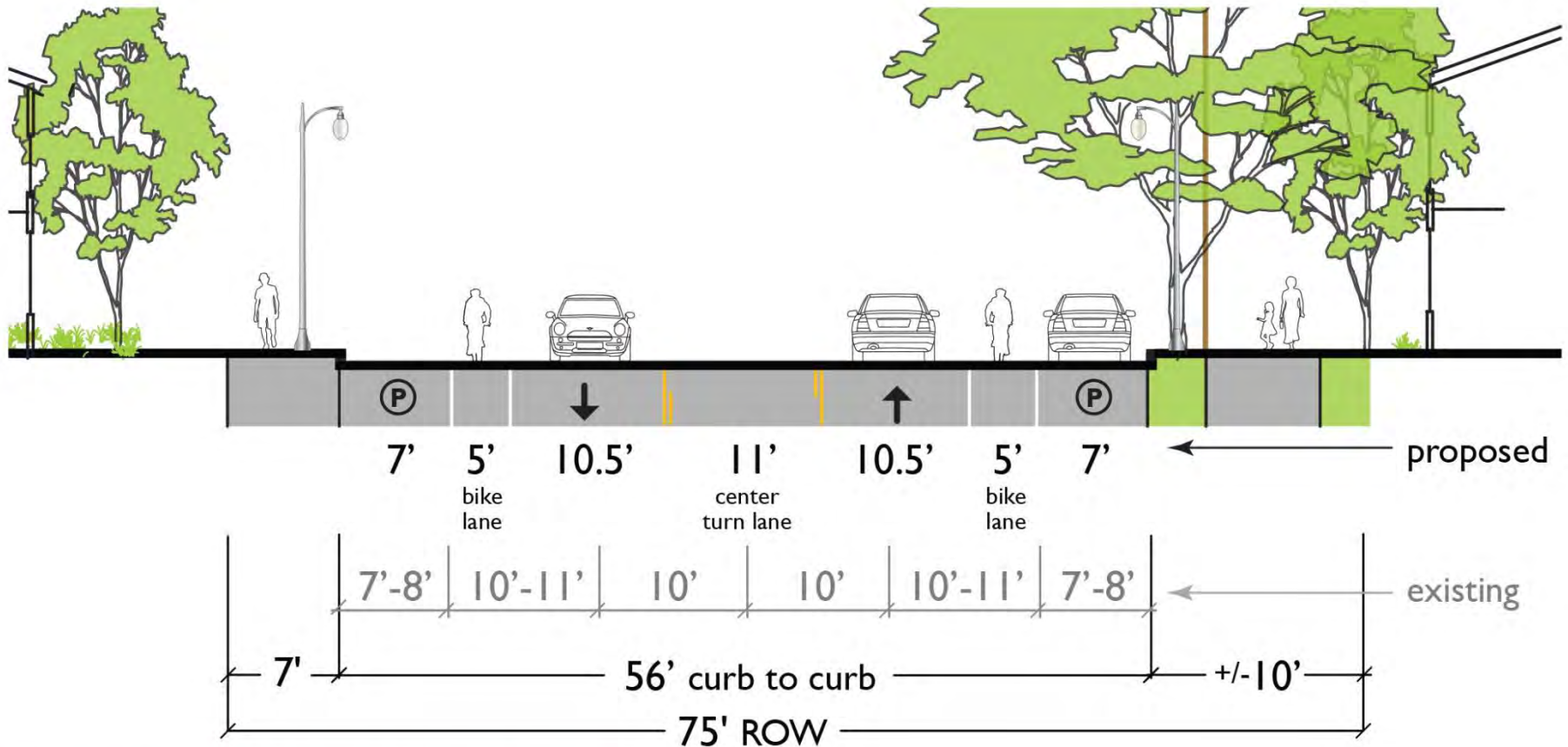

Section K (see next sheet)

Concept Design: Ninth to Caroline

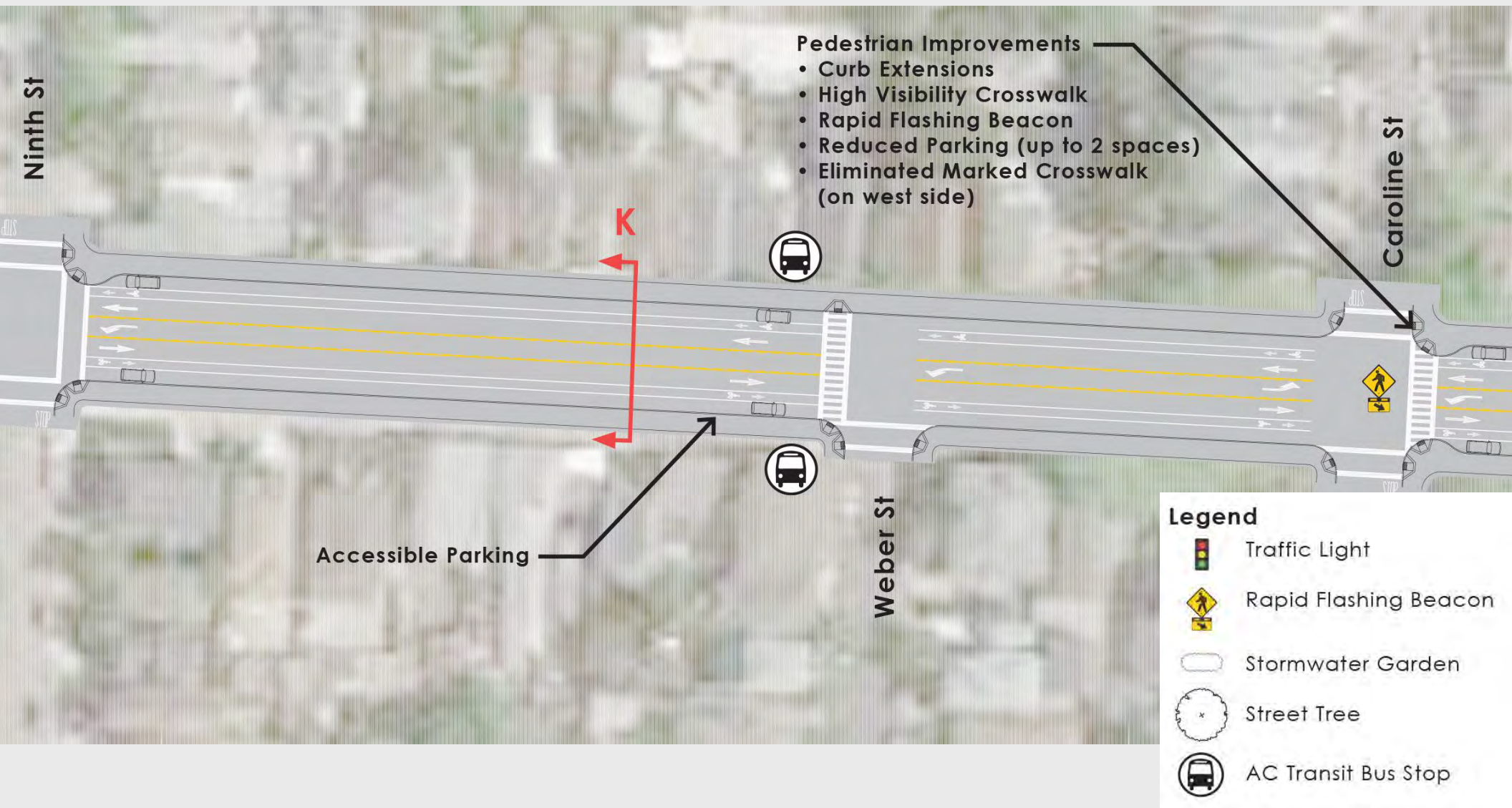

Concept Design: Caroline to Bay



Concept Design: Sherman/Encinal

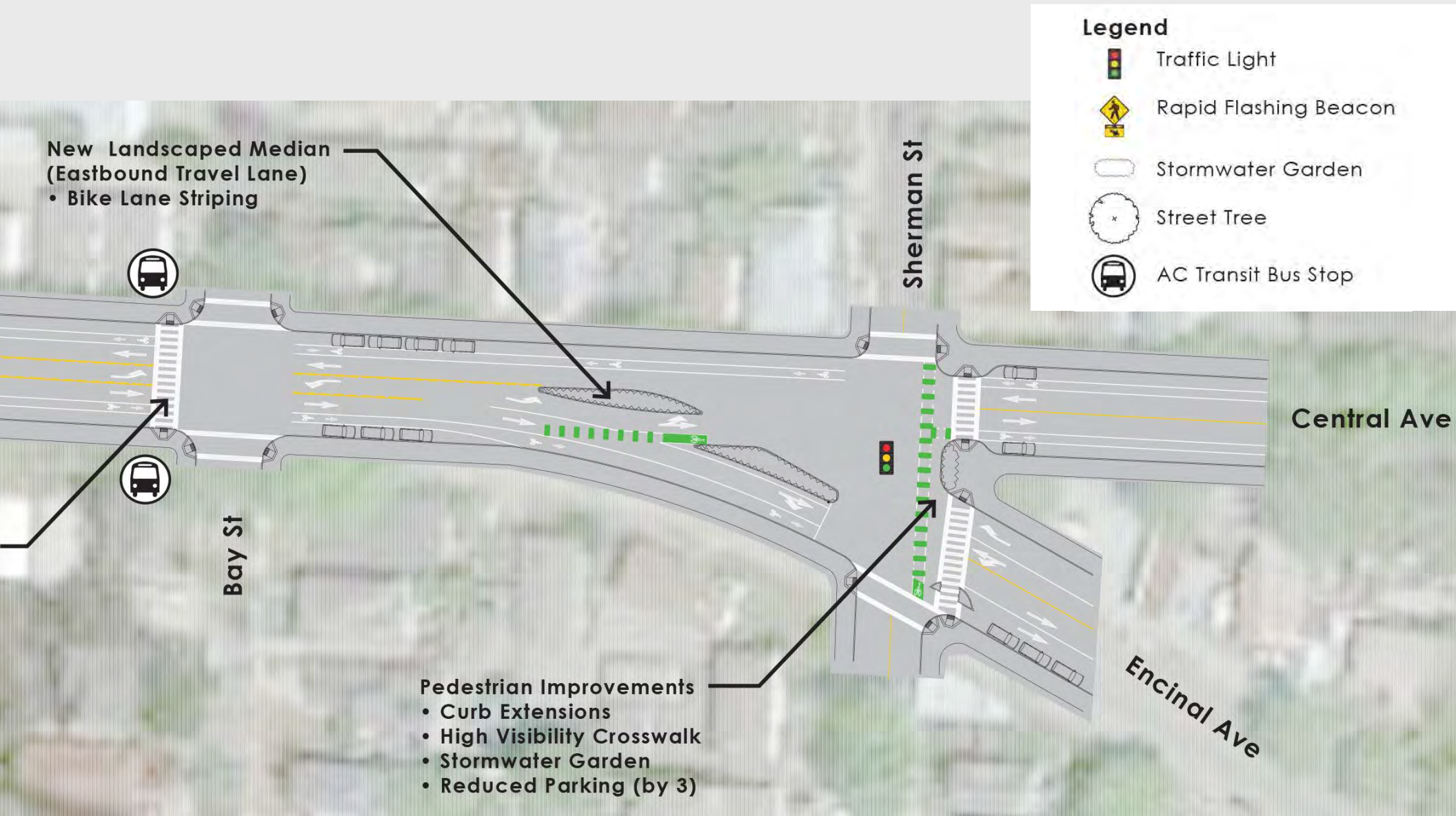

FHWA Guidelines

- **TWO-WAY SEPARATED BIKE LANE (CYCLETRACK)**
 - Prohibit parking within 20' from edge of driveway, and landscape/street-side elements within 15'
 - Skip Striping at Conflict Areas
 - Signs: “DO NOT ENTER” with “EXCEPT BICYCLES”, or “BIKE LANE” (and/or use a delineator post on the centerline)



FHWA Guidelines

- **MIXING ZONE:** an area where bicyclists and right-turning automobiles merge into one travel lane approaching an intersection.
 - Shared Lane Markings (“Sharrows”)
 - Signs: “BEGIN RIGHT TURN LANE YIELD TO BIKES”



FHWA Guidelines

- **LATERAL SHIFT:** moves cyclists to the left of the motor vehicle right turn lane before vehicles can move right.
 - Skip Striping in Conflict Areas and Bike Boxes
 - Signs: “BEGIN RIGHT TURN LANE YIELD TO BIKES”



FHWA Guidelines

■ ACCESSIBLE PARKING

- 5' wide minimum access aisle provided at street level, and 3' wide front and/or rear aisles
- Crosswalk and curb ramp connecting access aisle to sidewalk
- Signs: “YIELD HERE TO PEDESTRIANS” at crosswalk

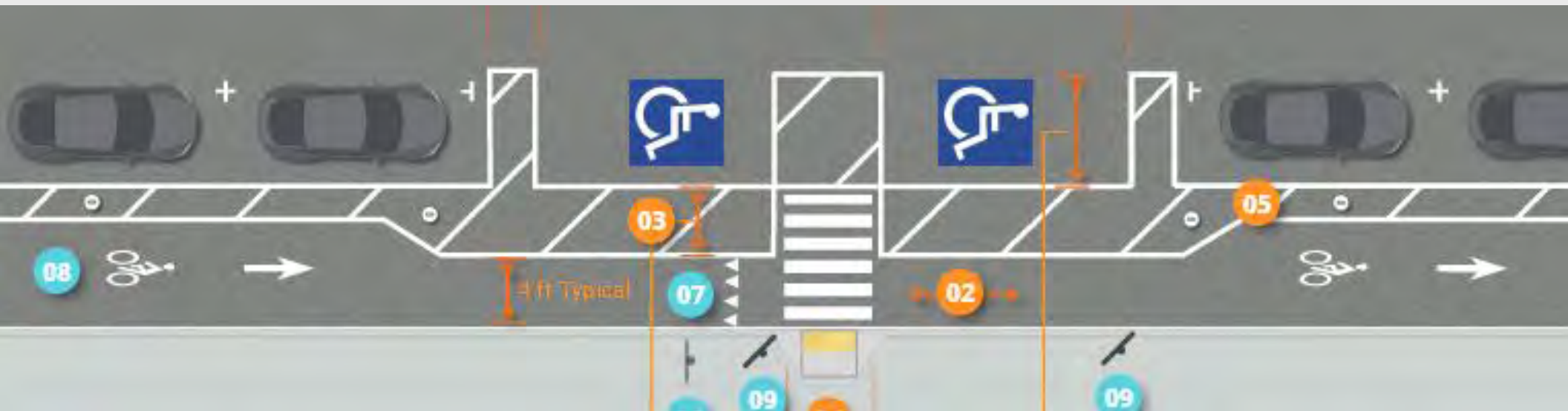

Traffic Analysis (cont.)

Driveway Counts:

	North/East	South/West	Total
Pacific/Main to Lincoln	14	1	15
Lincoln to Third/Taylor	12	4	16
Third/Taylor to Fourth	9	1	10
Fourth to Sherman/Encinal	86	70	156
Total	121	76	197

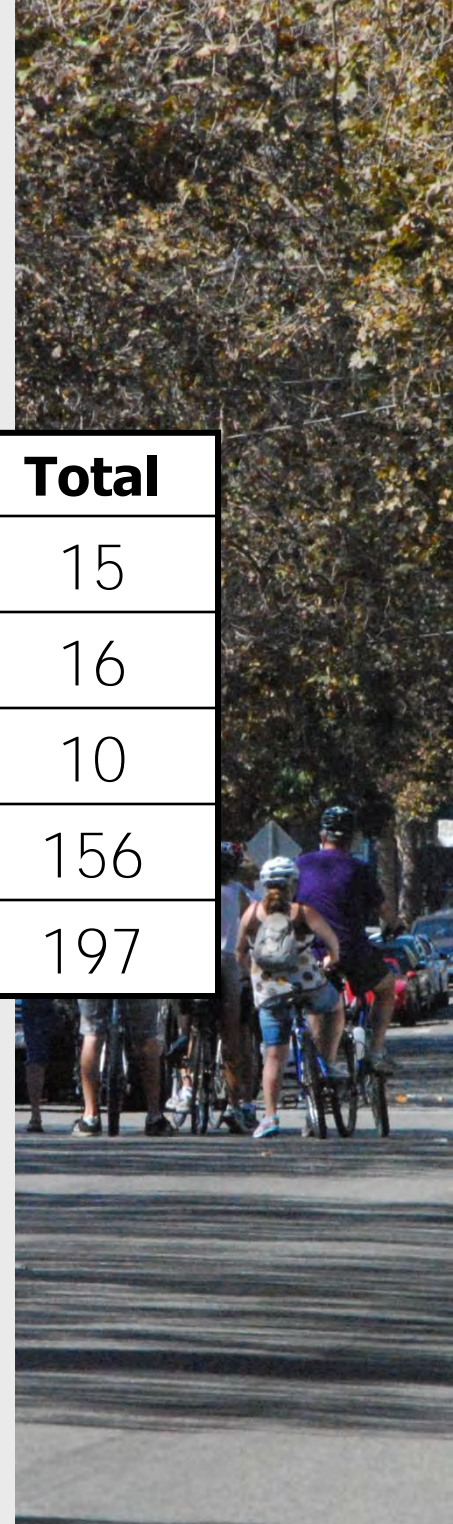
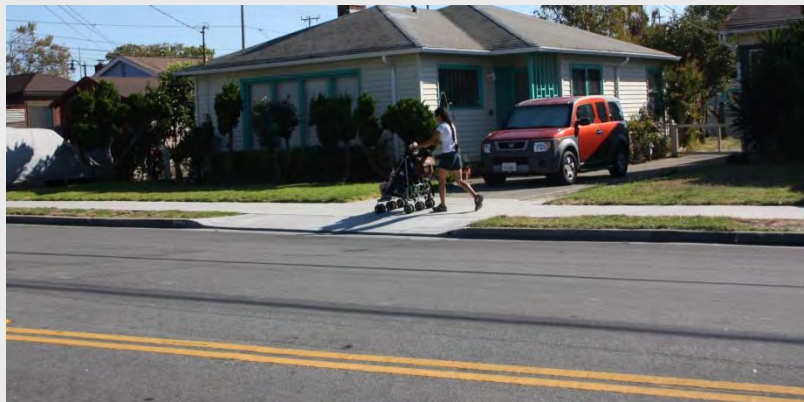

One-Way Cycle Track (Protected Bike Lanes)



Central Avenue Proposed Street Concept

Two-Way Cycle Track



Central Avenue Proposed Street Concept