



Amy Wooldridge
Recreation and Parks Director
City of Alameda

City Aquatic Center

City of Alameda
Community Workshop #2



City Aquatic Center

City of Alameda



For today.....

1. *Recap of Community Workshop #1*
2. *Presentation of Concepts*
3. *Charette – Concept Evaluation*
4. *Team Presentations*
5. *Next Steps*

A photograph of a community workshop event. In the foreground, a young girl with blonde hair and braces, wearing a colorful patterned jacket, smiles at the camera. In the background, several people are engaged in conversations. A man with glasses on the left holds a white envelope. A woman with blonde hair in a bun stands with her back to the camera. The room has wood-paneled walls and a chandelier. Blue informational banners are visible on the right side of the frame.

Community Workshop #1 Recap

Club
City Ac

5

- What are the group and M
- Competition touch pads, system?
- Dedicated sp Lockers? Sto
- Water depth



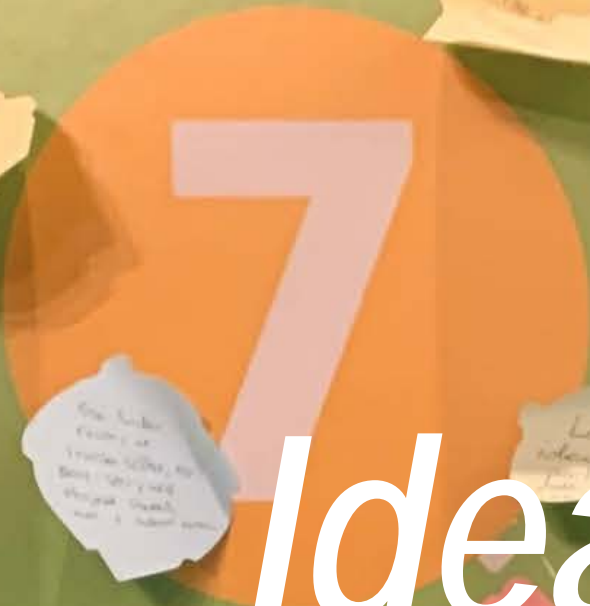

Idea Tree

We will not be able to be at the meeting but would like to write our request for that ADA access which must be at least 30" wide and at least 48" long to allow people to be able to change in and out of swimsuits. Please get this into your notes, and thanks for the outreach.

make it's open during open school hours

Beach entry for seniors + disabled

Beach entry for seniors + disabled

I just received an email regarding a new City Aquatic Center. I'm wondering if there is a splash pad in the plans. I have three young children and have been hoping for a different way to get my kids outside in water during the summer without having to go to the beach every time. My kids are fun and under, so we haven't been able to enjoy the local swimming pools yet because I take them everywhere so my son and I can manage them. Anyway, I'm always looking for something fun and do outside and Alameda does a great job checking high of the buses, but a splash pad would be great in your time!

Including a splash pad & hot summer days

WIPES FOR CHILDREN w/ DISABILITIES

SIMILAR TO SN AP. IN BOFFELY

WIPES

Fun pool for kids

Pool hours

Bring in...

Offer water polo training class for parents

Space for shower for residents to

People Juggling

There are...

Water slide to splash pad

Water stand @ camp pool w/ shade

Offer Discount Rates for Seniors

What a treat!

Somen...

80...

Swimmer

Adults...

1 ARCHITECTURAL COMMENTS

1A FUN/WARM WATER

Disabilities

Aquatics for special needs

Similar to S.N.A.P. in Berkeley

Make accommodations for disabilities a selling point

Provide warm water therapy pool with steps, ramp, and/or chair transfer

Warm Water

I want the pool to have a big whirlpool area!

Definitely want warm water/therapy pool for seniors.

Pool Features

We need a fun pool year-round, drop-in rate—there are plenty of lap pools already.

Water slide, inflatable obstacle course, lazy river

!!!Fun water!!!

Shallow, Zero entry pool for little kids

Lazy river and a drifting area

A bucket waterfall

Would love a fun pool like they have in Lynnwood, WA!

If 30m + 25m option w/ no fun water, please at least include splash pad/wade pool area

No splash water features – it's hot hot enough in Alameda

Fun water park

Waterslide

Waterslide, splashpad, Lazy river, drop-in daily, moms w/ kids

Lazy river! and Inflatable obstacles (ex. The Plunge in San Diego)

My kids vote for fun pool w/ lazy river and splash pad w/ waterfall bucket

Seconding a splash pad for non-swimmers to enjoy

Fun pool for kids

Fun water park!

Beach entry for seniors and disabled

Indoor water slides, water aerobics (make sure accommodates for seniors/disabled)

Love Silliman Aquatic Center in Fremont

Love the Lazy river!

Splash Pad

A fun pool for kids and Hot Tub

1B FAST WATER

Pool Size

50 meter pool is better than 2 separate pools

50 meter x 25 yard pool

Alameda has a strong swimming community, need 50 meter pool

50 meter and 25 yard conversion ability

Consider 50 meter x 25 yard pool

Why have such a big fast pool?

The ability for water polo to be played. 25 meters, floating cages and 25 yards wall cages

Pool Features

High dive!

Depth of lap pool should be at least 4 feet

Competition pool needs timing systems, touch pads, etc

Automotive covers and lane lines

There are some nice example facilities through the tunnel; Encinal HS pool, too (run by city)



1C POOL DECK

Pool Deck Features

Cool areas to hang out and watch kids swim
Spectator stands @ comp pool w/ shade
Covered bleachers
Covered bleachers
For competition pool, do not integrate the timing system into the pool deck. They just corrode and short out.

1D POOL CHEMISTRY

Pool Chemistry

Salt water
Salt water or bromine
Non-chlorine pool
Non-chlorine water for skin sensitivity
Is a non-chlorine pool an option? Would love that!

1E INDOOR POOL BUILDING

Desire for Indoor Pool

Fun pool indoors and competition pool outdoors
Indoors so we can use year-round
I vote for a covered pool that can be used in the winter months.

1F SUPPORT BUILDING

Entry

2 Doors: One community door, one AHS door
Secure area to park bikes (safe, in view, no lock needed)
Make ease of access to the entry from accessible parking a priority; level, shortest path.

1F SUPPORT BUILDING

Locker Rooms

Locker rooms with benches and lockable lockers
Better locker room/changing areas
Try and get progressive on restroom facilities to accommodate gender neutral
Gender neutral changing areas!
See: Locker room at Incline Village, NV pool – very well-designed shower area and locker area
Locker room should have those swim suit “spinners”
Separate sports and recreation locker rooms
Space for school swim teams

Building Operations

Solar! Solar! Solar!
Use solar panels for heating pool and building
Very interested in solar power
Interested in the all-electric concept
Solar? To help heat with electric heating. Or are Amps that cheap?

1G CONSTRUCTION

Construction Operations

Recycle demolition materials
Reuse materials like demolition concrete to reduce the embodied carbon



2 OPERATIONS COMMENTS

2A OPERATIONS

Fees

Have day passes (single use) at a reasonable price

Please have a membership option

Offer discount rates for seniors

Love this idea! Fun pool w/ daily/hourly rate would be AMAZING!

Uses

Space and time for older residents to swim

Alameda has lots of swim options if you are a child, a senior citizen, or unemployed. But for ordinary working people who want to do laps after work there is just Mariner Square.

Hopeful for gators to have better opportunities to train!

Lanes for casual adult swimming

Regular/daily lap swim times year round

Lap swimming for non-competitive swimmers who want exercise

Have lost of lanes for lap swimming and open lap swim hours every day

Make sure it's open during school hours

This is so exciting! I would love to see the best possibility that could serve all of community

Facilities Operations

Local youth hiring preference

Pool maintenance needs to be a priority

Maintained and run by ARDD not the school!

Take over ASPA!

Make Lincoln + Franklin play pools

It would be great to be able to host competitive swim meets

Polo and tournaments

Programming

Therapy programs like Palm Springs

Adult-only swim times

Classes for children w/ disabilities

Offer kayak rollover training classes to raise revenue



Good



Better



Best...Civic



Indoor Pool.....

3 IDEAS

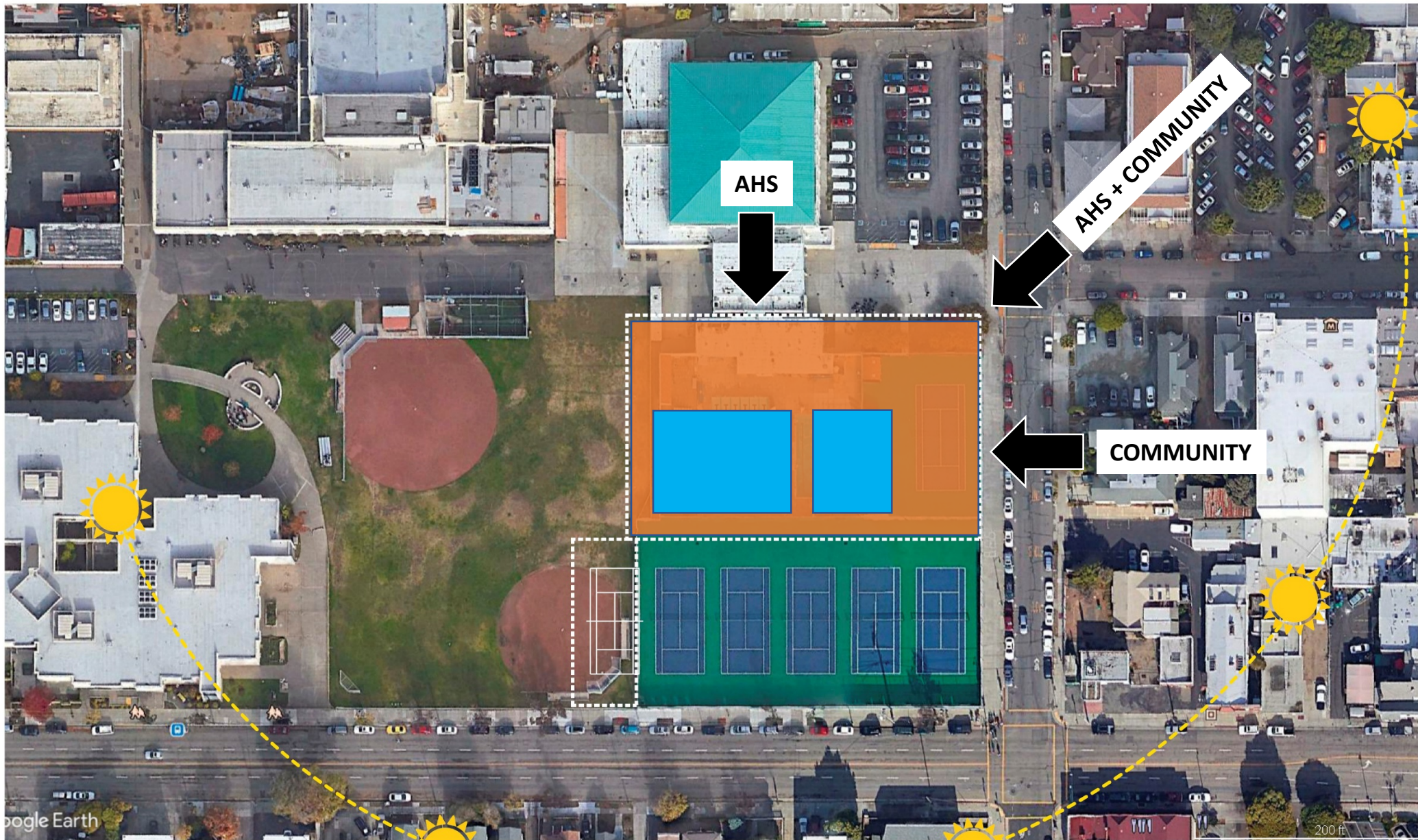

ALAMEDA CITY AQUATICS CENTER SITE



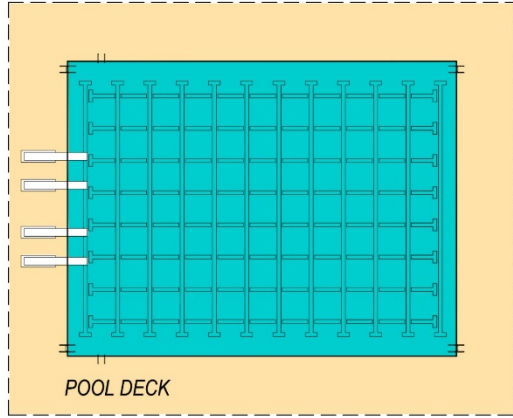

30M X 25Y COMP POOL

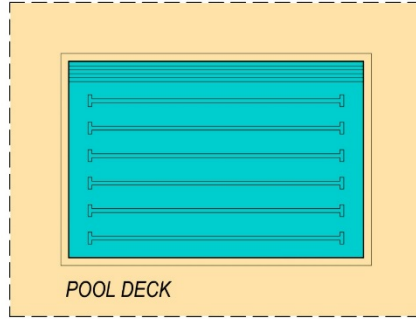

25Y REC POOL

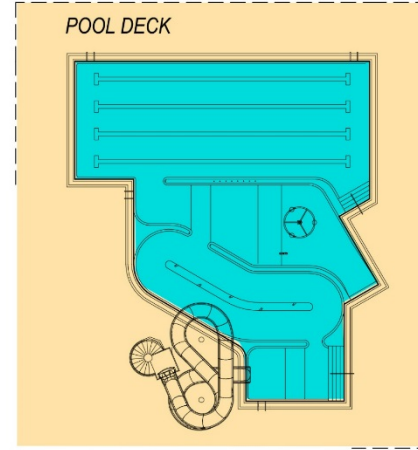

FUN WATER POOL



MULTI USE ROOM

KIT OF PARTS

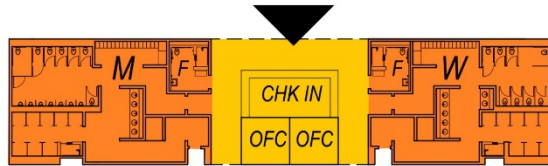

LOCKER RMS - OPTION 1

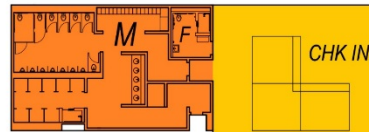

LOCKER RMS - OPTION 2

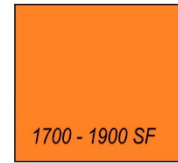

POOL EQUIPMENT



STORAGE

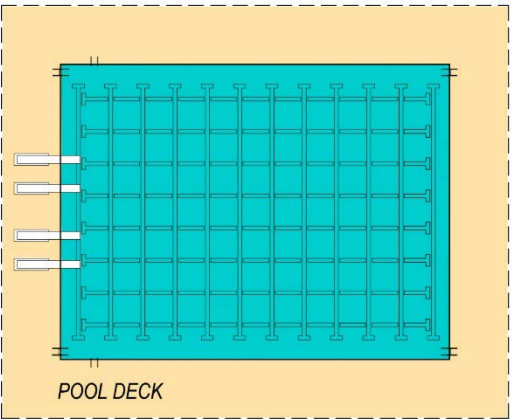
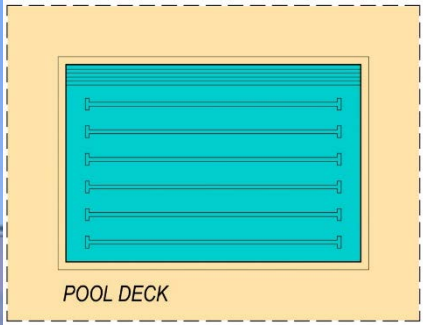

30M X 25Y COMP POOL

City of Morgan Hill

MASTERS/COMP/LAP SWIM

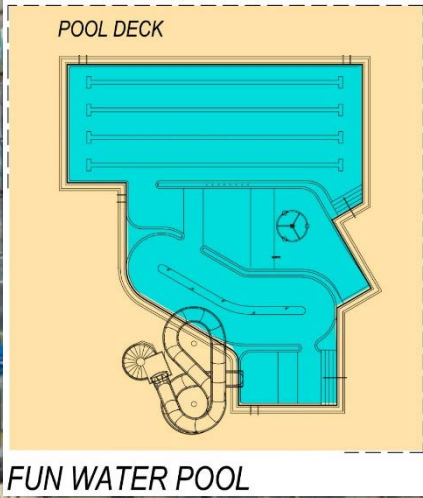

City of Oakland

WARM WATER – PLAY & LESSONS



OPTIONS

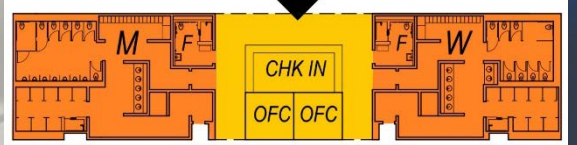

LOCKER RMS - OPTION 1

City and County of San Francisco
LOCKER ROOMS



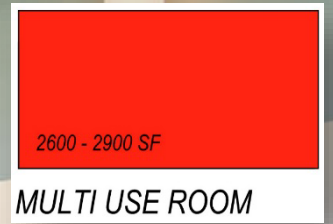
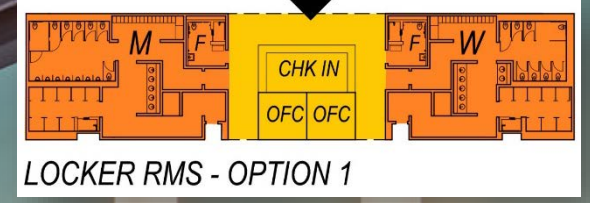

City and County of San Francisco
COMMUNITY MEETING SPACE

2600 - 2900 SF
MULTI USE ROOM



COMMUNITY MEETING SPACE

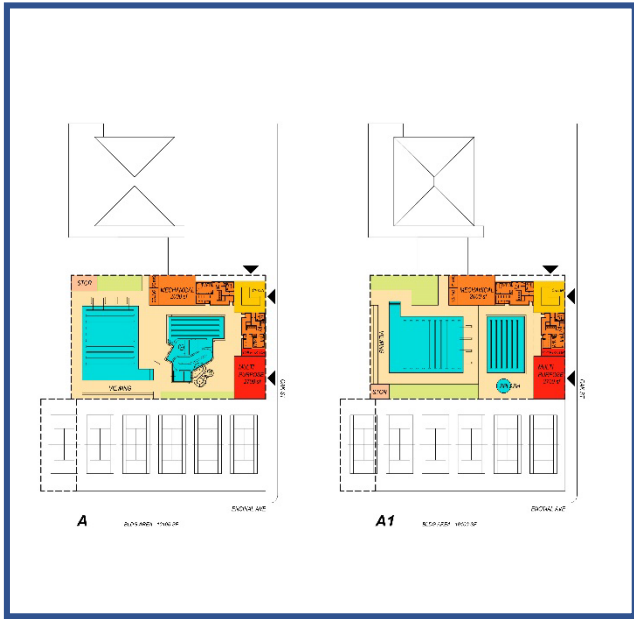

A

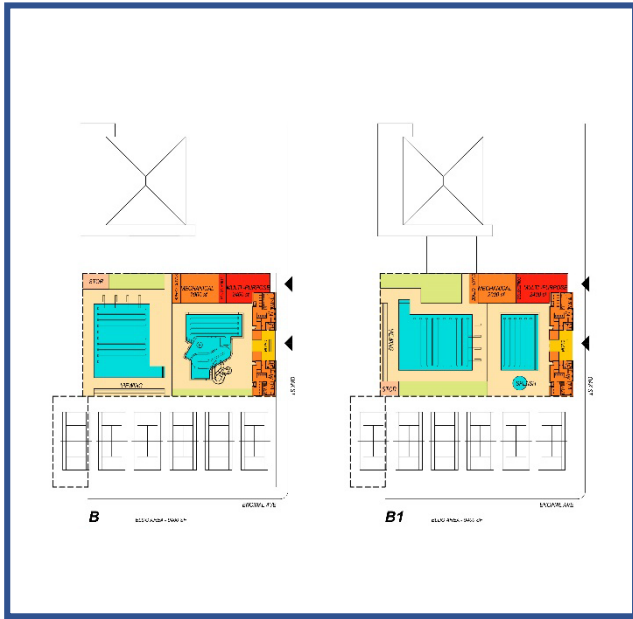

B

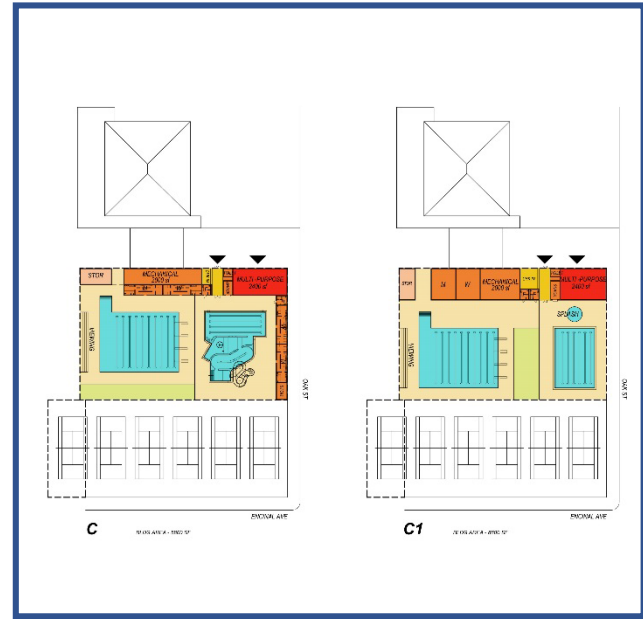

C

A



A

BLDG AREA - 10100 SF



SWIM

TRUCKEE
POLICE



CITY AQUATIC CENTER
CITY OF ALAMEDA





CITY AQUATIC CENTER
CITY OF ALAMEDA



B

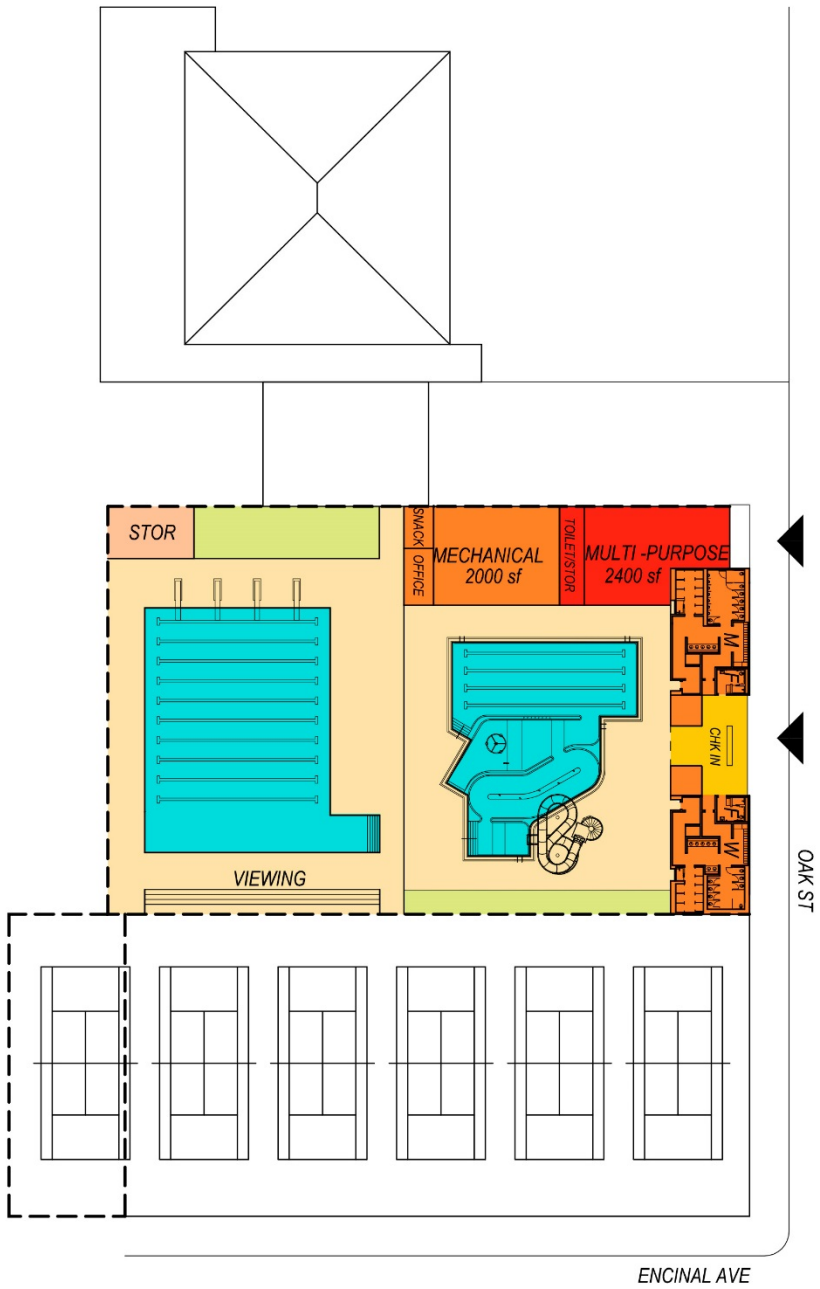

B

BLDG AREA - 9400 SF



SWIM







CITY AQUATIC CENTER
CITY OF ALAMEDA

C

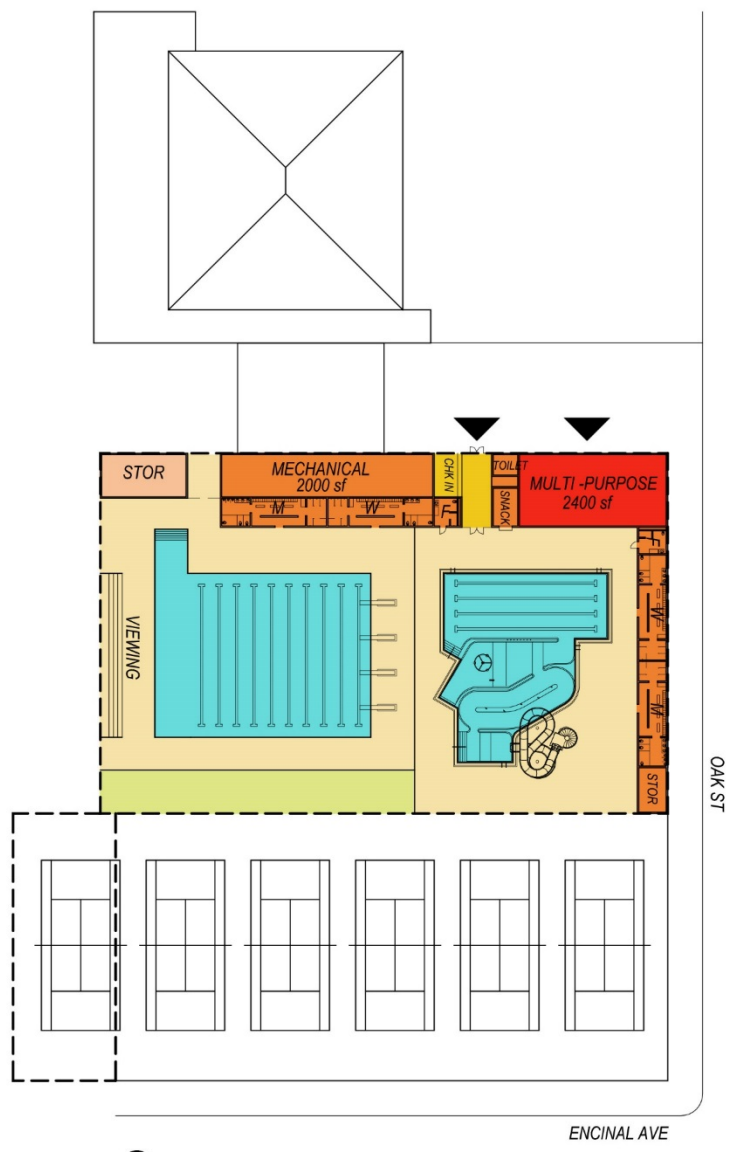

C

BLDG AREA - 8800 SF





THE
SUNSHINE
CENTER





CITY AQUATIC CENTER
CITY OF ALAMEDA



EVALUATION



Thank you for attending Workshop #2. After looking over options A, B and C please answer the following questions. The goal of the small group discussions is primarily to coalesce around broad themes and ideas, and less to arrive at project details. Following the discussions, each table will have two minutes to present their ideas to the workshop.

<p>Please circle the answer that best supports your opinion:</p> <p>Where should the entrance to the facility be located?</p> <p>Oak Street Corner of Oak & High School High School</p> <p>How important is visibility into the aquatic center from Oak Street?</p> <p>Not Important It Would Help Very Important</p> <p>How important is having an indoor pool?</p> <p>Not Important It Would Help Very Important</p> <p>How important is access to the multipurpose room during off hours when the pools are closed?</p> <p>Not Important It Would Help Very Important</p>	<p>What activities do you see happening in the multipurpose room? <i>Ex: Community Meetings, Party Rentals, stretching space, classes...</i></p>
<p>Would you rather have...</p> <p>Visibility into the facility from Oak Street to connect public to the fun OR Privacy from those passing by on Oak Street</p> <hr/> <p>More fun water features such as slides, lazy river, beach entry... OR More warm water lanes for programming</p>	<p>What is most concerning? Are there community priorities you feel the site plan iterations did not address?</p>
<p>Any other thoughts you want to share?</p>	



Flat Water Programming Options:

Please circle your top 3 programs and rank them in order of importance from 1 to 3.



Learn to Swim



Lap Swim



Swim Teams



Water Aerobics

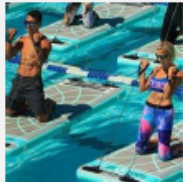

Aqua Yoga & Strength



Deep Water Running



Aqua Surf



Innertube Water Polo



Aqua Spin



Ahi Chi



Canoe Battleship



Water Slack Lines



Fun Water Pool Features:

Please circle your top 3 fun water features and rank them in order of importance from 1 to 3.



Zero Beach Entry



Little Kids Slide



Water Canons



Spray Features



Water Flow Discovery



Water Bubblers



Playground Structure



Large Water Slide



Lazy River



Waterfall Mushroom



Dump Buckets



Pipe Sprayer

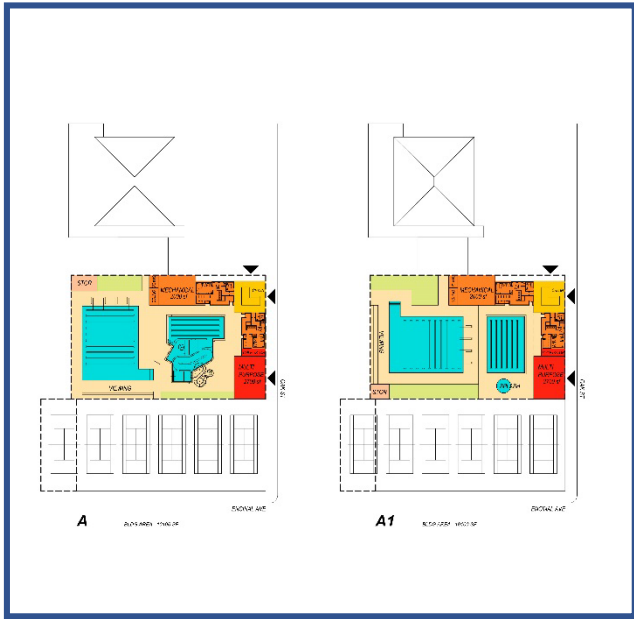

A

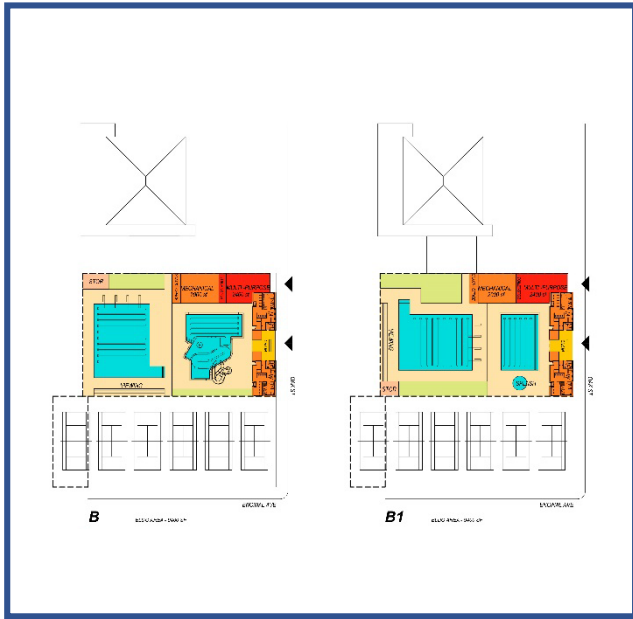

B

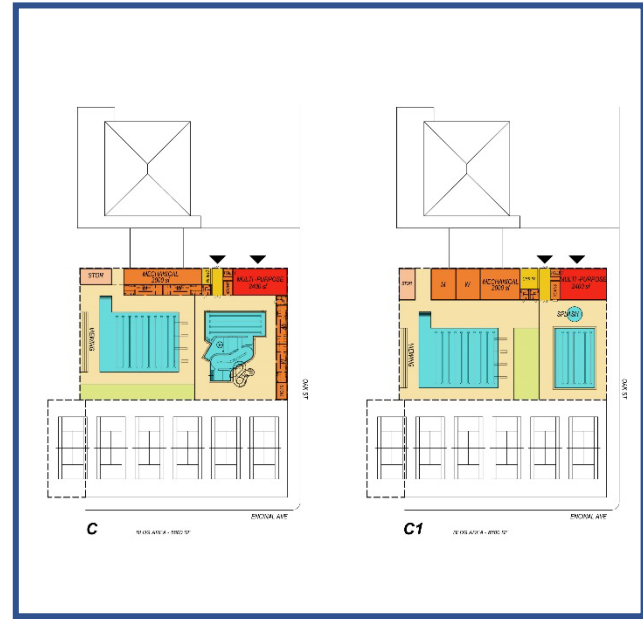

C

Charette Process

- 1. Form Teams*
- 2. Elect a Captain*
- 3. Discuss and Evaluate Concepts.....fill out your forms*
- 4. Captains present findings*

20 Minutes

TEAM PRESENTATIONS

3 MINUTES EACH

Team 1 -

Team 2 -

Team 3 -

Team 4 -

Team 5 -

Team 6 -

Team 7 -



NEXT STEPS