



*Amy Wooldridge*  
*Recreation and Parks Director*  
*City of Alameda*

# *City Aquatic Center*

*City of Alameda*  
*Community Workshop #3*



# *City Aquatic Center*

*City of Alameda*











# WORKSHOP #2



***3 IDEAS***



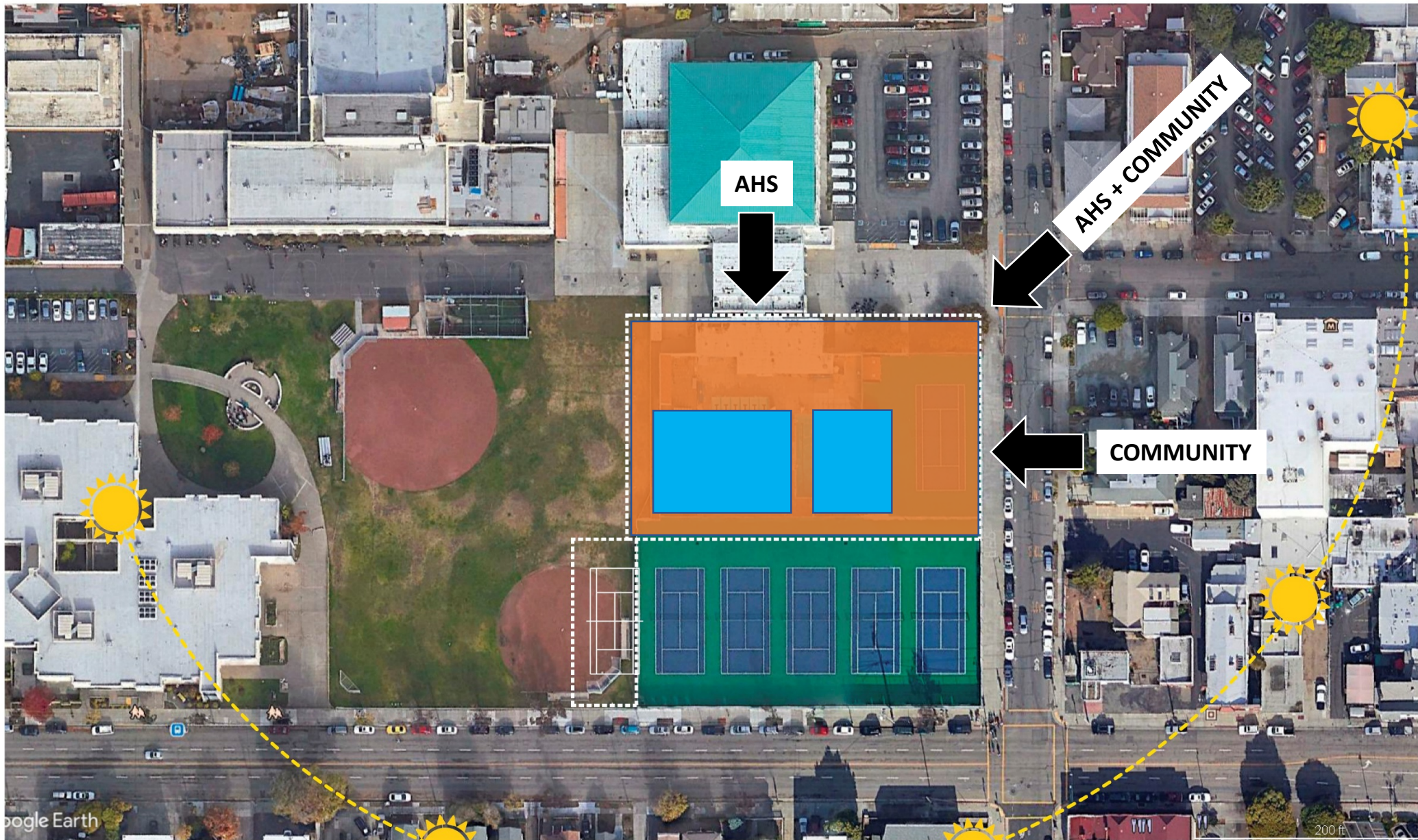

ALAMEDA CITY AQUATICS CENTER SITE





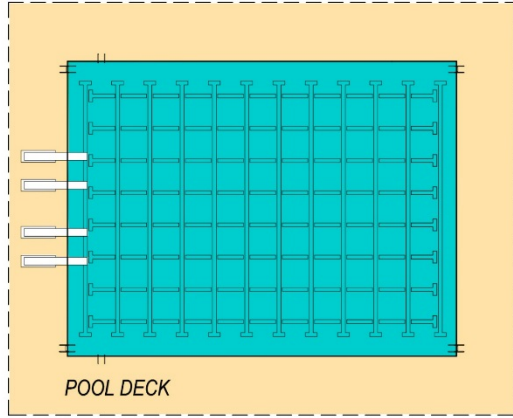

30M X 25Y COMP POOL

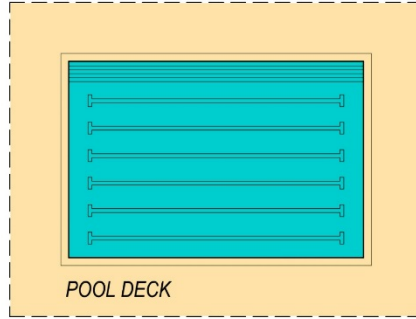

25Y REC POOL

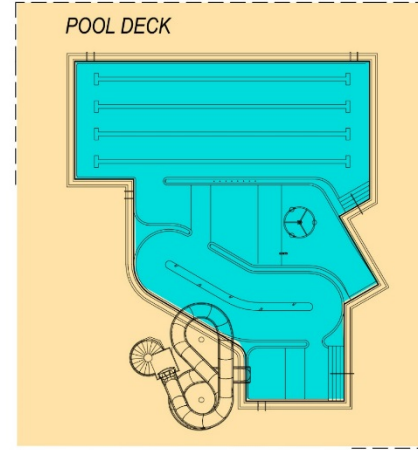

FUN WATER POOL



MULTI USE ROOM

KIT OF PARTS

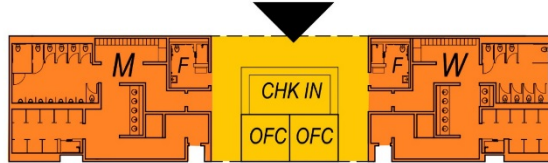

LOCKER RMS - OPTION 1

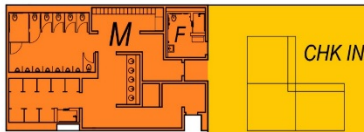

LOCKER RMS - OPTION 2



POOL EQUIPMENT



STORAGE



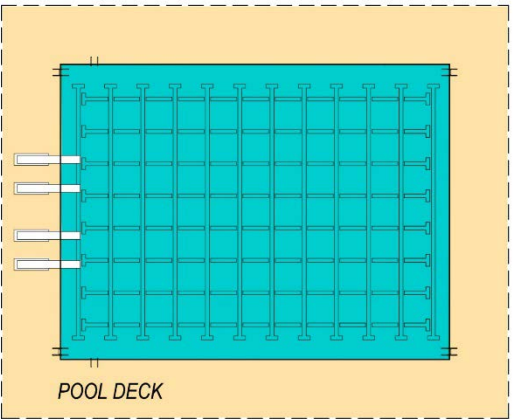
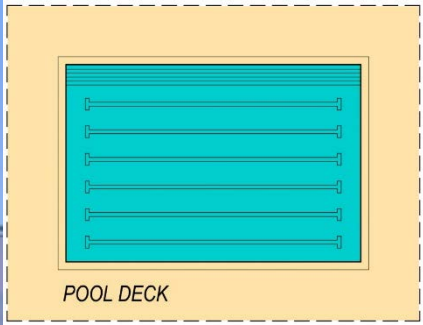

30M X 25Y COMP POOL

City of Morgan Hill

# MASTERS/COMP/LAP SWIM



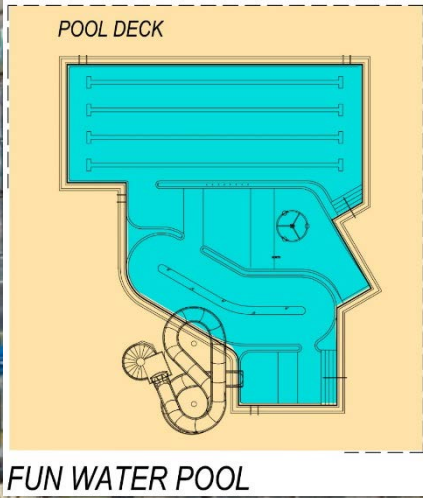

City of Oakland

# WARM WATER – PLAY & LESSONS





FUN WATER ..... OPTIONS



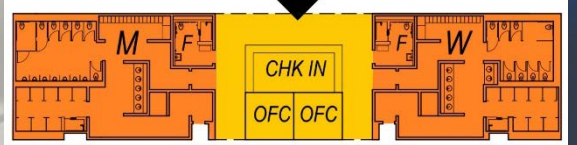

LOCKER RMS - OPTION 1

City and County of San Francisco  
**LOCKER ROOMS**





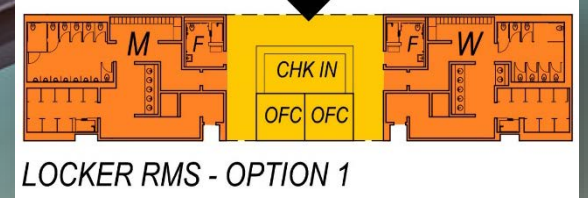

City and County of San Francisco  
**COMMUNITY MEETING SPACE**



2600 - 2900 SF  
MULTI USE ROOM



COMMUNITY MEETING SPACE



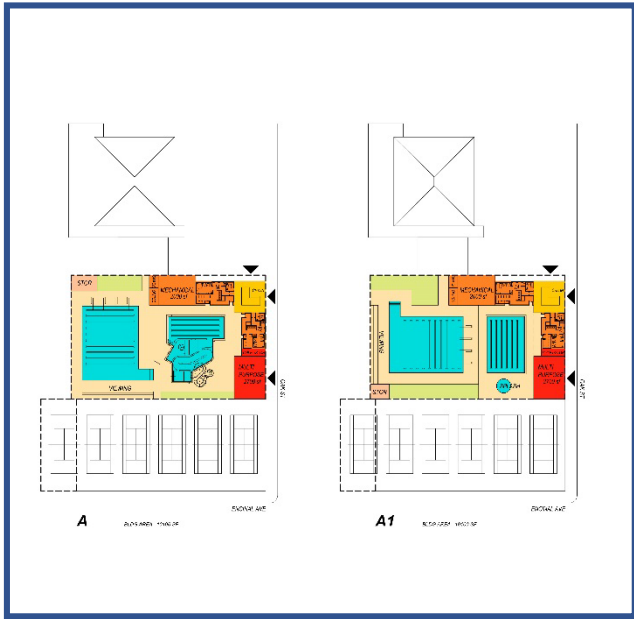

**A**

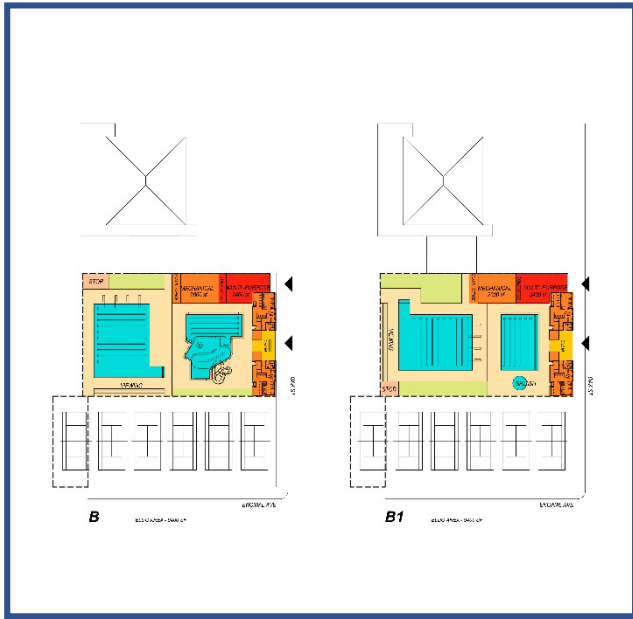

**B**

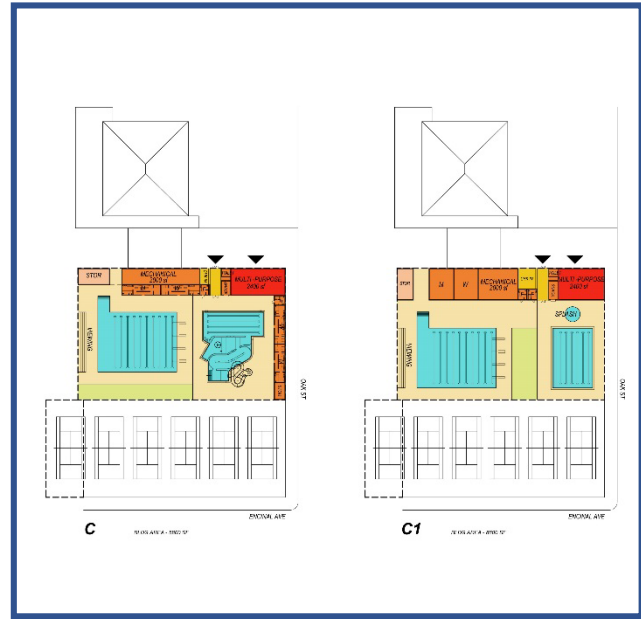

**C**

# A



## A

BLDG AREA - 10100 SF



# B

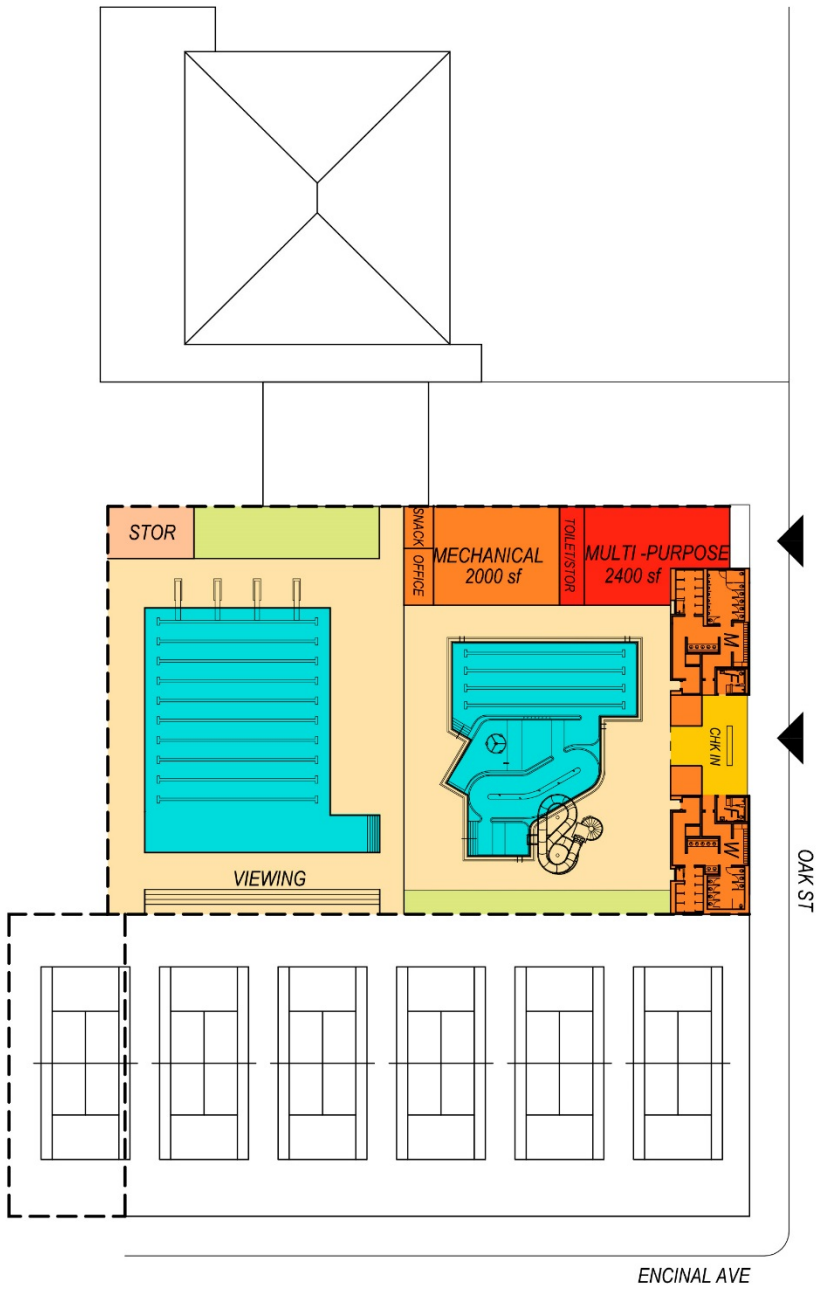

**B**

BLDG AREA - 9400 SF



C

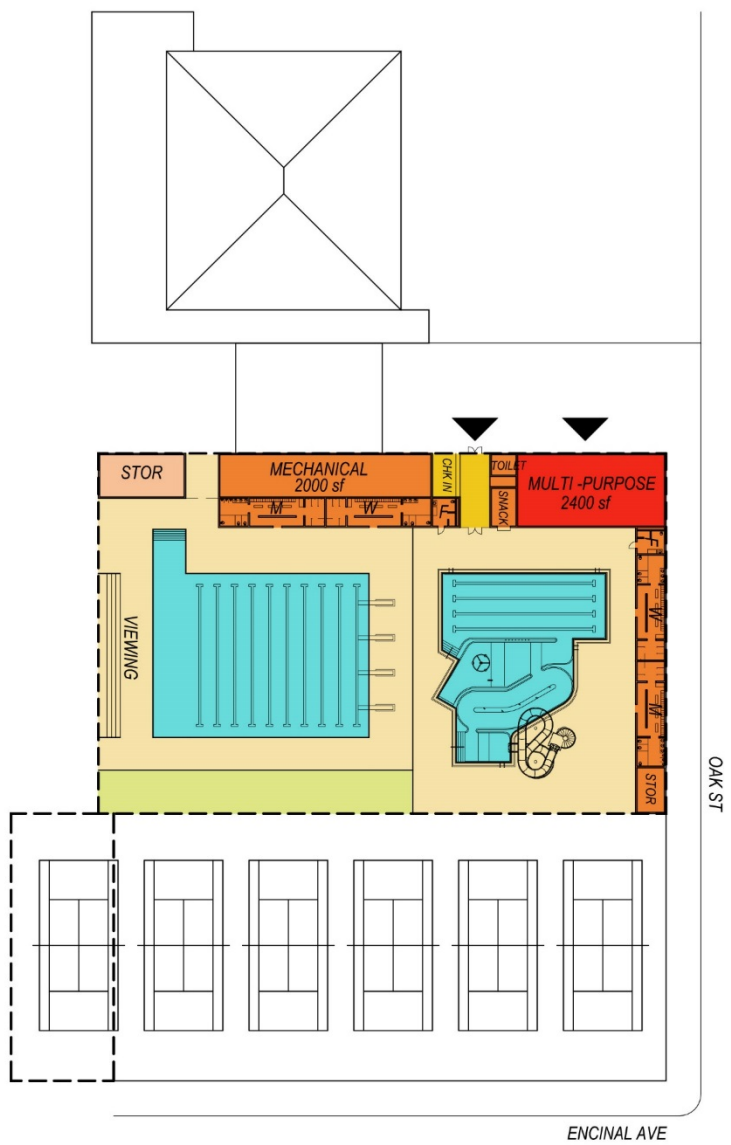

C

BLDG AREA - 8800 SF



*EVALUATION*





Thank you for attending Workshop #2. After looking over options A, B and C please answer the following questions. The goal of the small group discussions is primarily to coalesce around broad themes and ideas, and less to arrive at project details. Following the discussions, each table will have two minutes to present their ideas to the workshop.

Please circle the answer that best supports your opinion:

**Where should the entrance to the facility be located?**

Oak Street	Corner of Oak & High School	High School
------------	-----------------------------	-------------

**How important is visibility into the aquatic center from Oak Street?**

Not Important	It Would Help	Very Important
---------------	---------------	----------------

**How important is having an indoor pool?**

Not Important	It Would Help	Very Important
---------------	---------------	----------------

**How important is access to the multipurpose room during off hours when the pools are closed?**

Not Important	It Would Help	Very Important
---------------	---------------	----------------

**What activities do you see happening in the multipurpose room?** *Ex: Community Meetings, Party Rentals, stretching space, classes...*

**What will this facility bring to the community?**

**Would you rather have...**

Visibility into the facility from Oak Street to connect public to the fun	OR	Privacy from those passing by on Oak Street
More fun water features such as slides, lazy river, beach entry...	OR	More warm water lanes for programming





**What is most concerning? Are there community priorities you feel the site plan iterations did not address?**

**Any other thoughts you want to share?**



**Fun Water Pool Features:**













Please circle your top 3 fun water features and rank them in order of importance from 1 to 3.

 Zero Beach Entry	 Little Kids Slide	 Water Canons
 Spray Features	 Water Flow Discovery	 Water Bubblers
 Playground Structure	 Large Water Slide	 Lazy River
 Waterfall Mushroom	 Dump Buckets	 Pipe Sprayer



**Flat Water Programming Options:**

Please circle your top 3 programs and rank them in order of importance from 1 to 3.

 Swimming Lessons	 Lap Swim	 Club Swim Teams & Masters Teams
 Water Aerobics	 1M & 3M Diving	 Competitive & Inertube Water Polo
 Aqua Surf	 Deep Water Running	 Aqua Spin
 Ahi Chi	 Aqua Yoga & Strength	 Water Slack Lines



# Design ideas.....most important?

**90%** said they'd like more spectator seating

**82%** said a Natatorium Would Help or is Very Important

**88%** said Entrance to the Center at Corner of Oak and High School

**60%** said visibility into the Center Would Help.

**60%** said Access to the Multipurpose Room During Off-Hours was Very Important.

# Fun Water Features vs. Warm Water Lanes

**53%** said Fun Water Features

**vs.**

**32%** said Warm Water Lanes



# Programs for Flat Water...most popular:

**86%** Swim Team

**82%** Lap Swim

**78%** Swim Lessons

**60 %** Water Polo

# Fun Water Features...most popular:

**69%** Zero Beach Entry

**56%** Lazy River

**43%** Large Water Slide

**43%** Play Structure







CITY AQUATIC CENTER  
CITY OF ALAMEDA













*PREFERRED IDEA*

els+

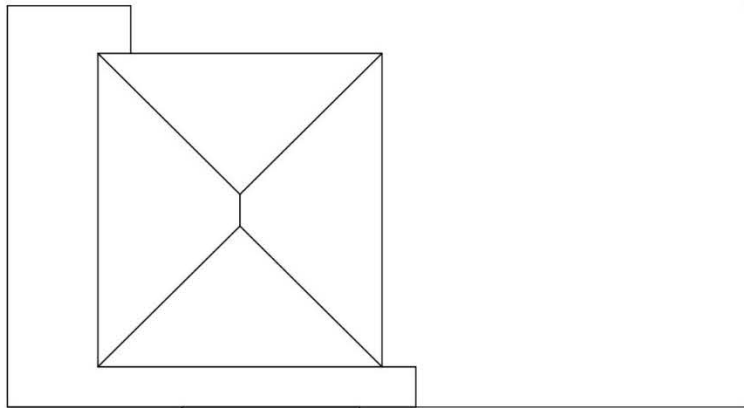

PREFERRED A

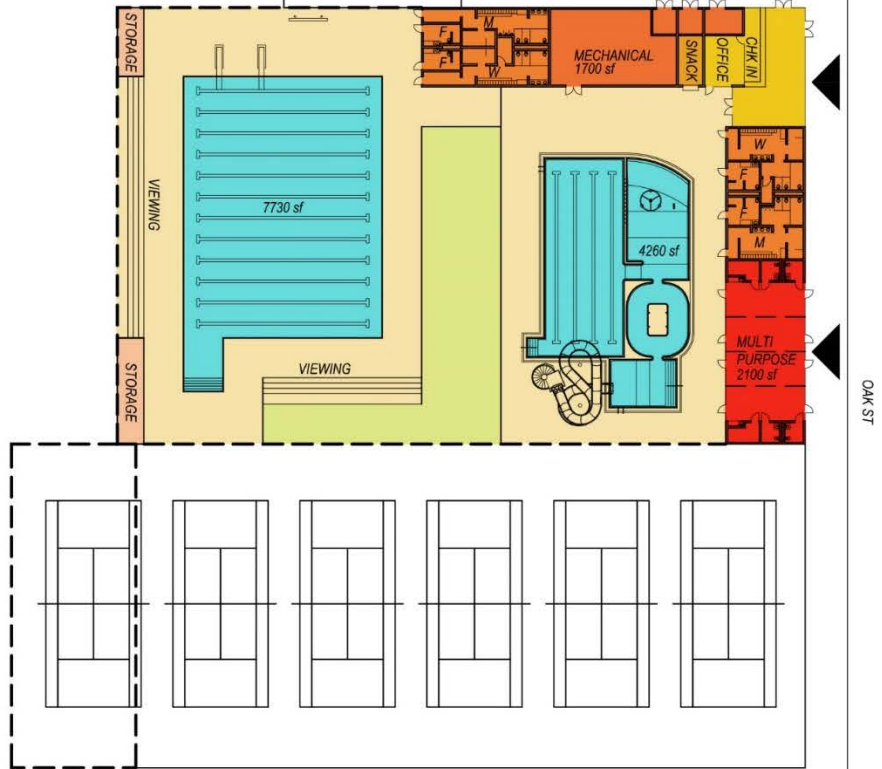

ENCINAL AVE

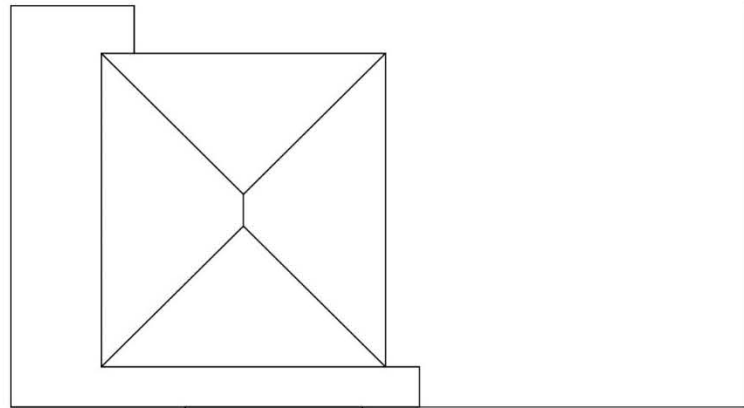

PREFERRED B

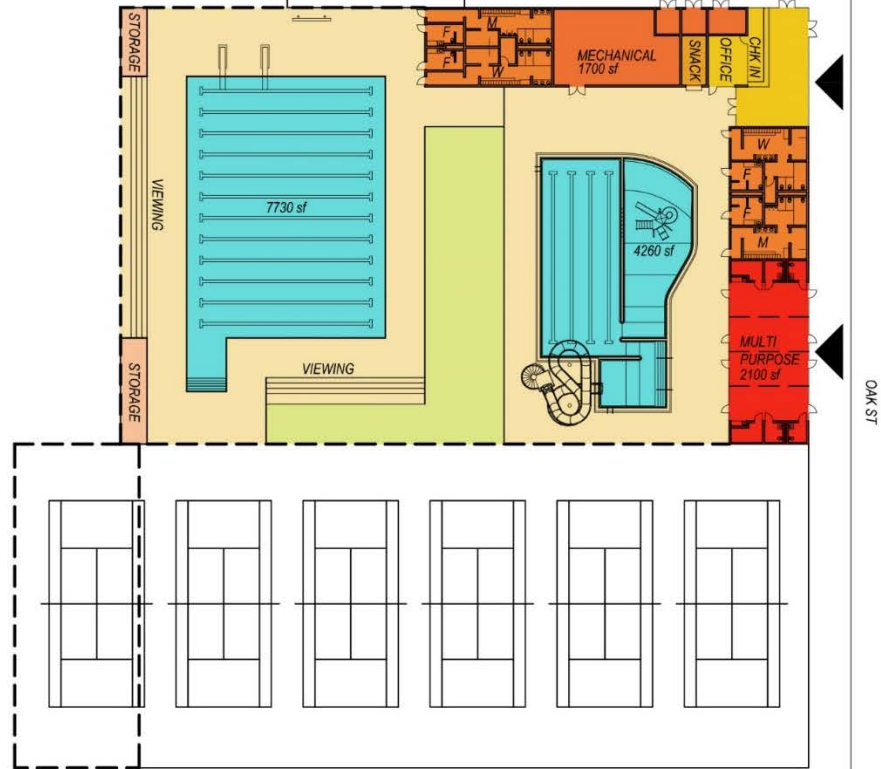

ENCINAL AVE





PREFERRED A



PREFERRED B





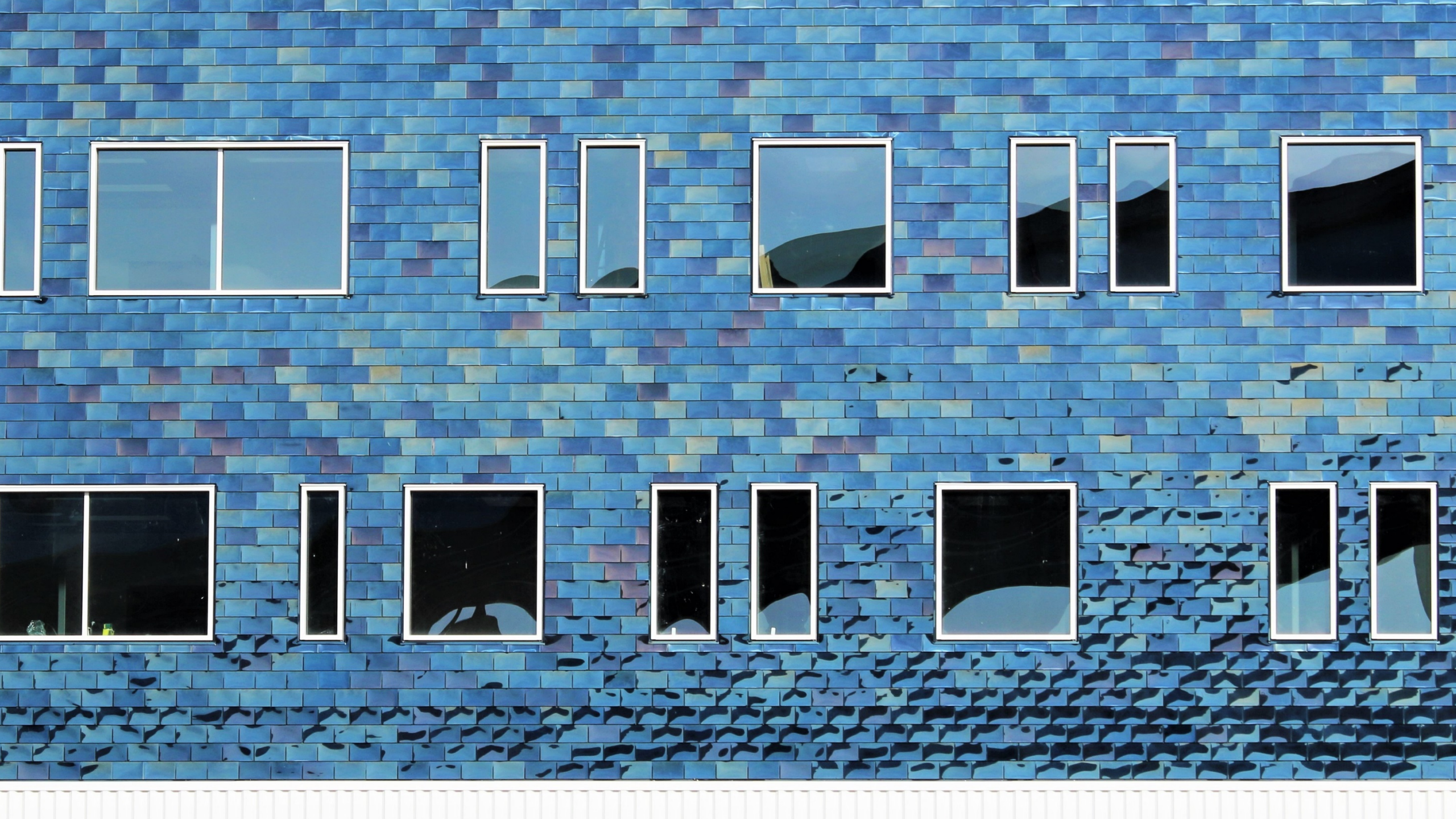







Preferred



CITY AQUATIC CENTER





CITY AQUATIC CENTER

CITY OF ALABAMA









Preferred w/Natatorium





CITY AQUATIC CENTER





CITY AQUATIC CENTER

CITY OF PALM BEACH













*Amy Wooldridge  
Recreation and Parks Director  
City of Alameda*

# *City Aquatic Center*

*City of Alameda*  
*Community Workshop #3*